



Seagate 8-Bay Rackmount NAS User Manual



Model: 8-Bay Rackmount NAS



Click here to access an up-to-date online version of this document. You will also find the most recent content as well as expandable illustrations, easier navigation, and search capability.

Contents

1	Regulatory Compliance	4
2	Introduction	5
3	Safety Guidelines	6
4	System Overview	7
5	System LEDs	8
6	Setting Up	9
7	Operation	10
8	Software	11
9	Hardware Maintainance	12
	Precautions	12
	Front chassis	12
	• Remove the front cover	12
	• Front chassis information	14
	• Replace a power supply unit (PSU)	16
	• Replace a hard drive	17
	• Replace a fan	22
	Rear chassis	24
	• Remove the rear cover	24
	• Rear chassis information	25
	• Installed components	27
	• Replace the battery	27
	• RAM	30
	• Adding a DIMM (RAM) to an empty slot	30
	• Remove a DIMM (RAM)	33
	Blinking purple LED: Confirm the connection	34
10	Getting Help	36
	Troubleshooting topics	36
	• The 8-bay Rackmount NAS will not turn on.	36
	• The 8-bay Rackmount NAS turns off when I connect a USB device.	37

Regulatory Compliance

Introduction

Safety Guidelines

System Overview

System LEDs

Setting Up

Operation

Software

Hardware Maintenance

The 8-bay Rackmount NAS has a front and rear chassis, each with its own cover. Review the details below for hardware module locations and, where applicable, replacement.

i Refer to the product's [Warranty](#) before performing any hardware repairs or maintenance that is not described in this manual.

Precautions

- Hot-swapping means that you can perform maintenance or upgrade hardware while the NAS is powered on. The 8-bay Rackmount NAS features three hot-swappable parts: hard drives; fans; and power supply units.
- Prior to performing hardware maintenance on other parts of the NAS (such as RAM and the battery), power off the product and disconnect the power from the power supply. Use NAS OS or a short push on the power button to shut down the NAS before unplugging the power cables.
- During operation, all provided hardware (including the installed drives in their frames) should remain in place for optimal air flow. Users with less than eight disks are not required to install empty disk trays in the enclosure. Airflow and fan performance are regulated by temperature.
- Observe all conventional ESD precautions when handling 8-bay Rackmount NAS parts. Avoid contact with backplane components and module connectors, etc.
- In most instances, the top cover should be removed only when the unit has been turned off and allowed to cool down. Potential hazards of opening the cover while the product is operating includes, but is not limited to, hot surfaces and exposed parts.

Front chassis

Remove the front cover

1. Power down the NAS using NAS OS and unplug the power supplies. Wait for the components to completely cool before moving to Step 2.
2. Slide the NAS toward you until it locks into position.

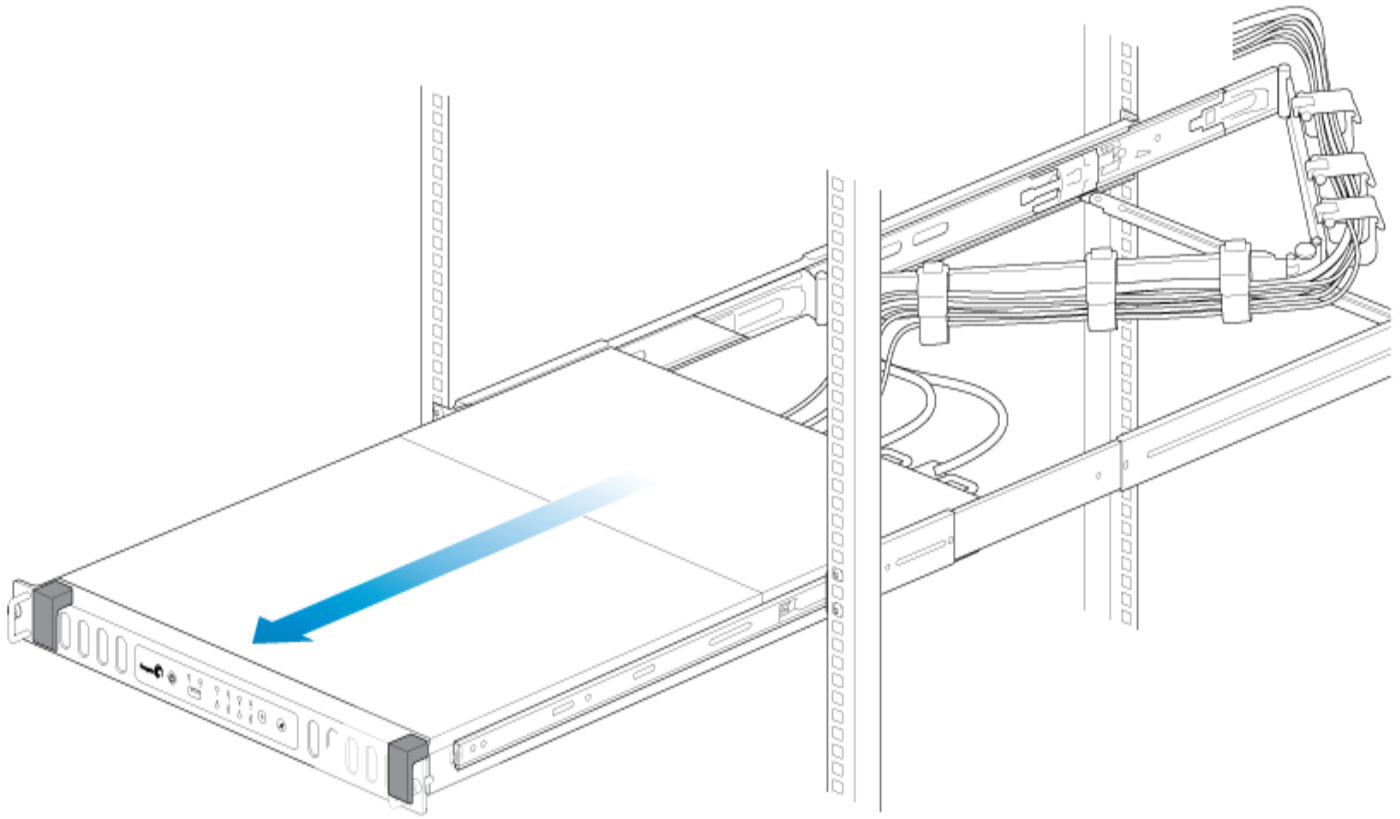

3. Release the cover by simultaneously pushing both front latches toward you.

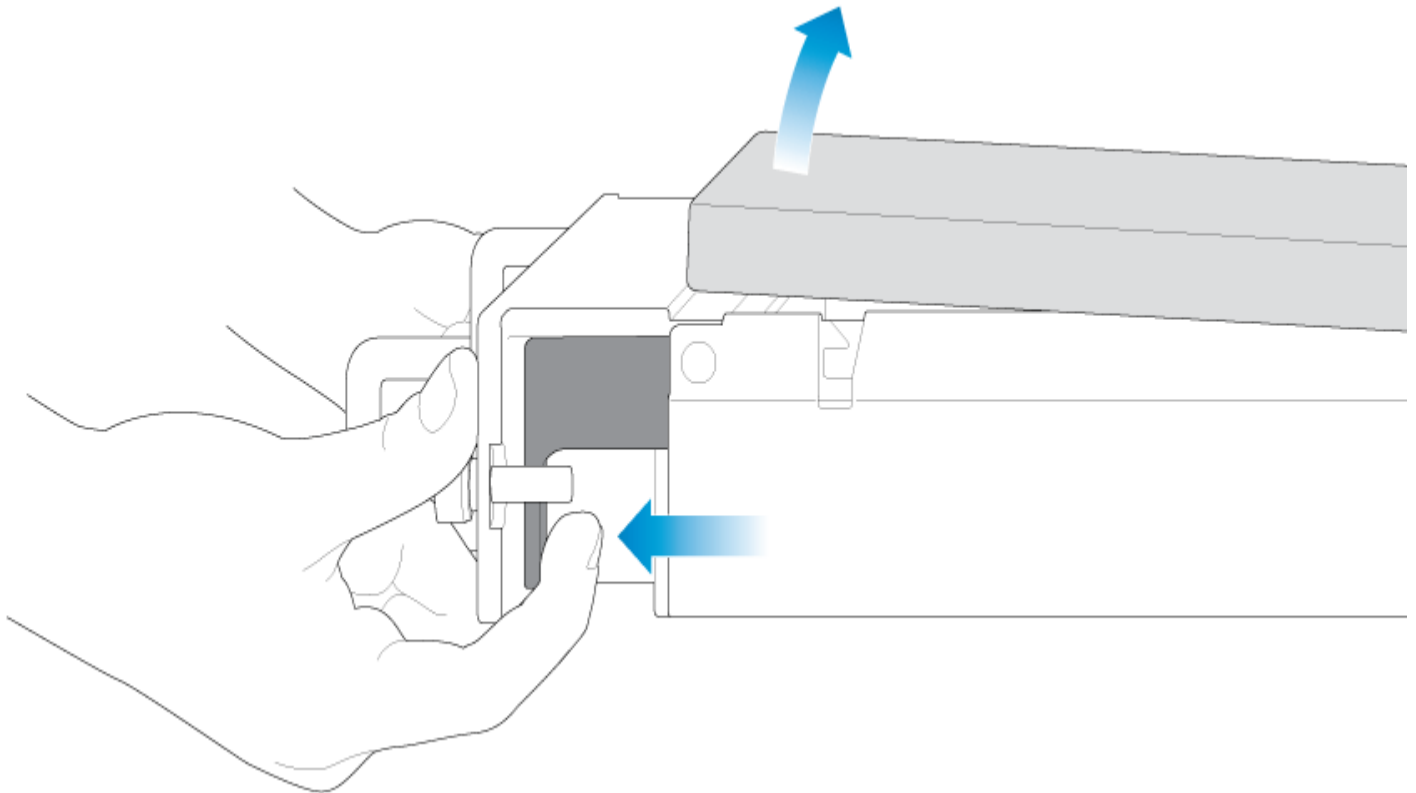

4. Lift the cover and remove it from the NAS.

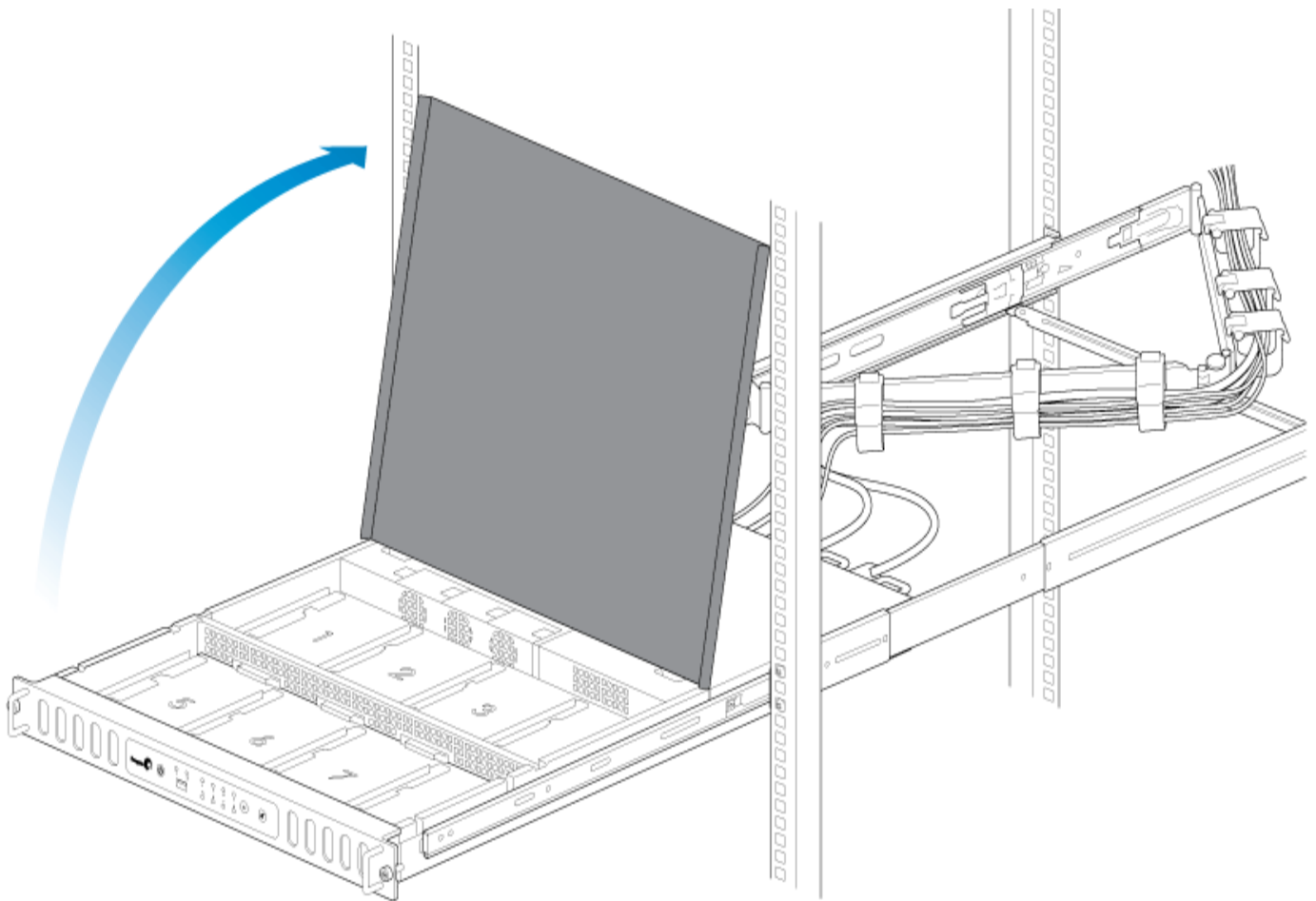

Front chassis information

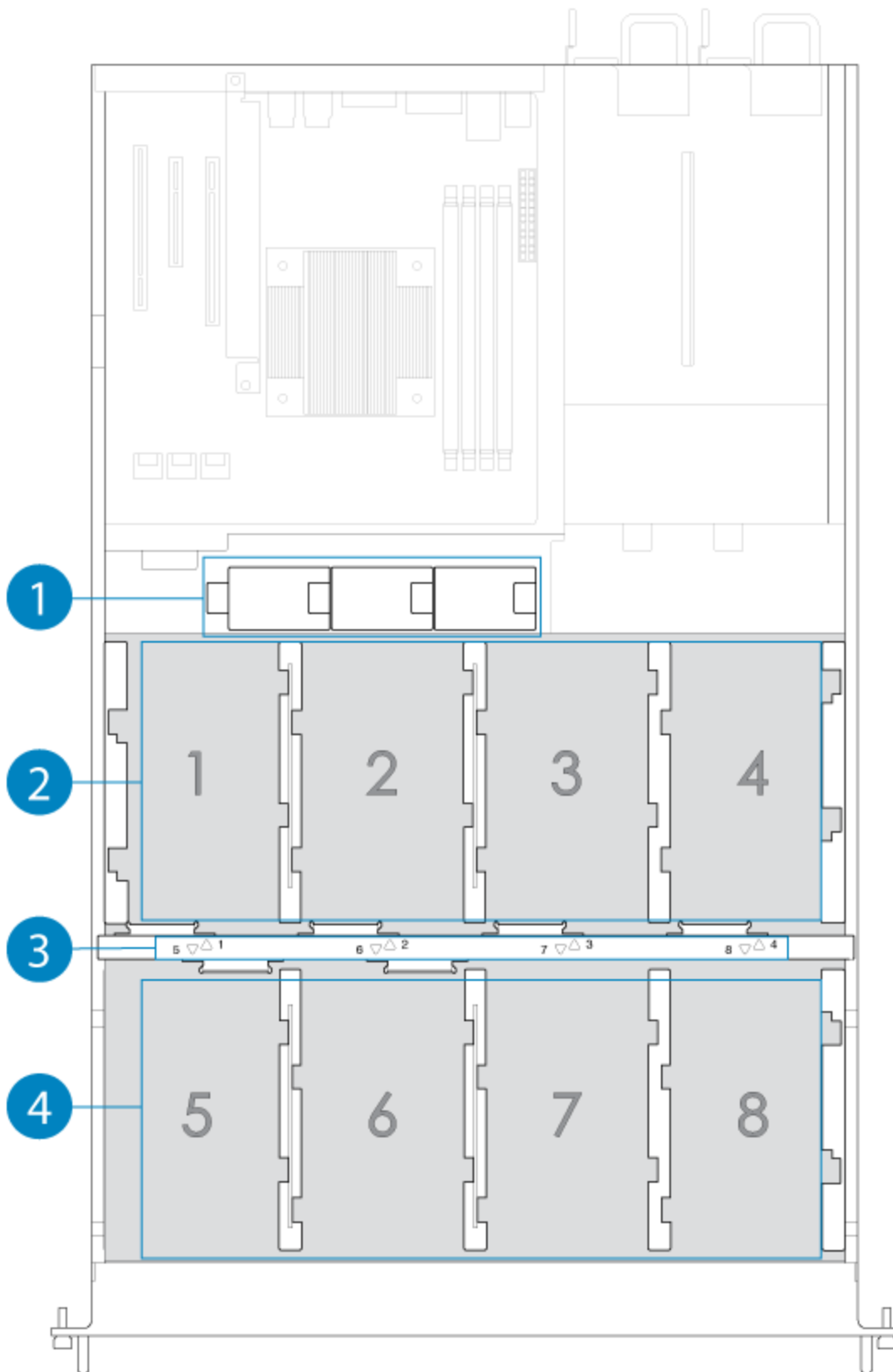

1. Fans (x3)
2. Frame 1, hard drives 1 - 4
3. Hard drive LEDs; SATA connections
4. Frame 2, hard drives 5 - 8

Replace a power supply unit (PSU)

For optimal power management, the power load for the NAS is shared between the two PSU. If one should fail, all power will automatically run from the active PSU, guaranteeing continuous NAS operation. To help extend the lifetime of your hardware, make certain to replace a failed PSU as soon as possible. Follow the instructions below to replace a PSU:

1. Locate the PSU on the rear of the NAS.
2. Unlock the PSU by pushing its latch toward the handle.

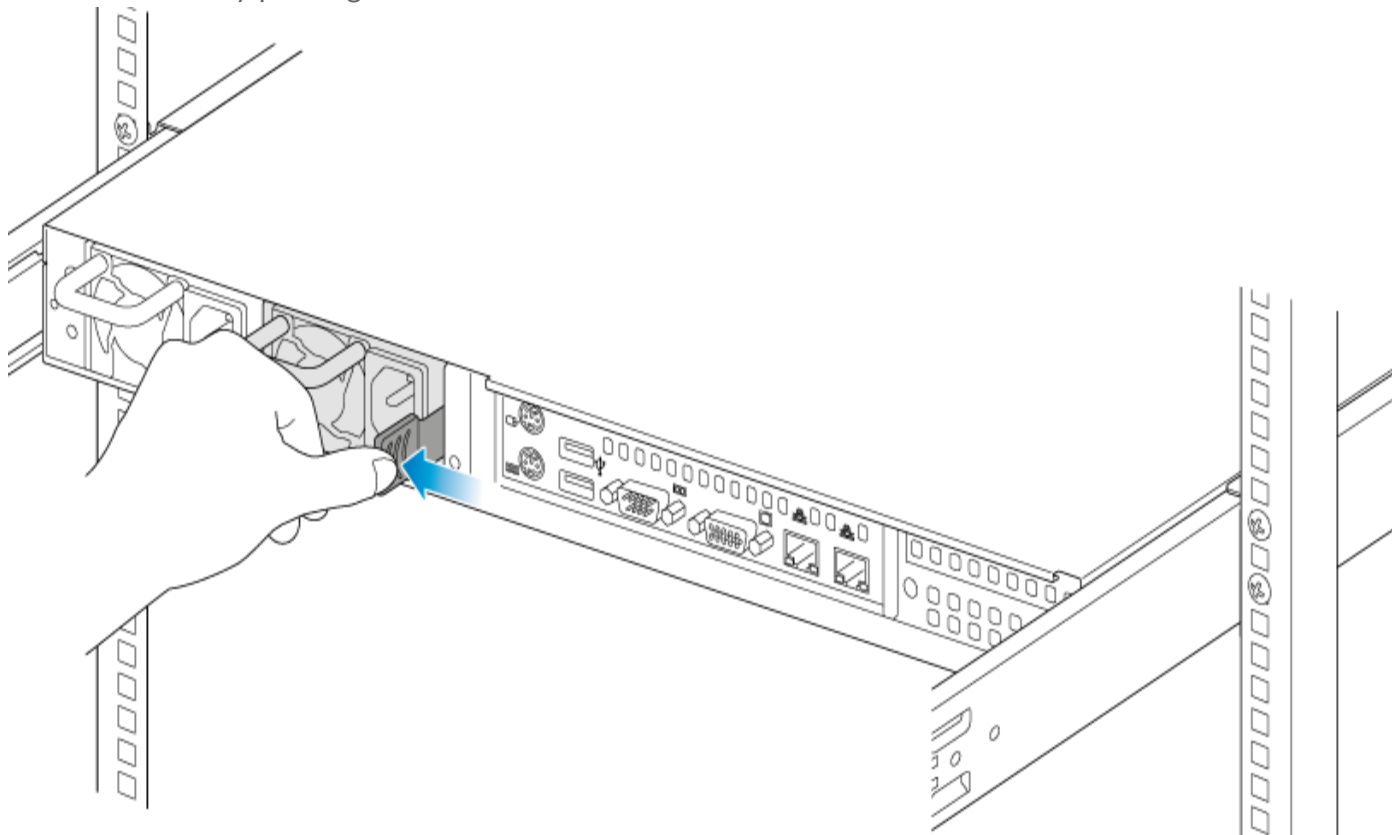

3. Remove the PSU by pulling the handle away from the NAS.

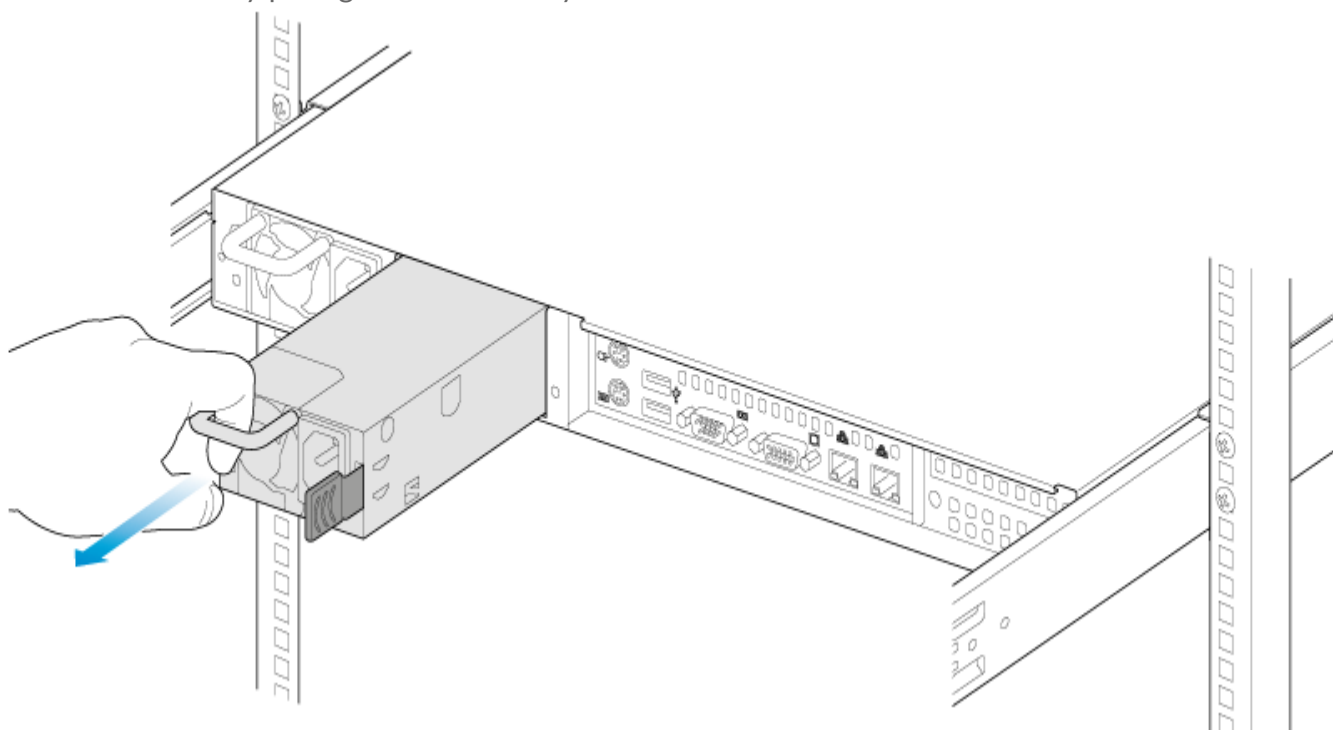

4. Insert the replacement PSU into the empty PSU slot.

Replace a hard drive

If a failed hard drive is under warranty, make certain to contact Seagate customer support to receive a replacement disk.

When adding or replacing hard drives, consider using Seagate hard drives that are optimized for use with your 8-bay Rackmount NAS. See [Seagate Enterprise Drives](#) for further information.



Important info:

Replace a faulty drive with a drive of equal or greater capacity.
When handling drives, make sure that they are placed (and stored) on a cushioned surface.



Important info: When following the instructions below, make certain to place the new or replacement disk on the drive guides before connecting the ends to the SATA ports. Attaching the drive to the SATA ports before placing it on the guides will damage the SATA connections.

1. Power down the system, unplug the power supply, and remove the cover as described above.
2. Push the disk's lock button to open the latch.

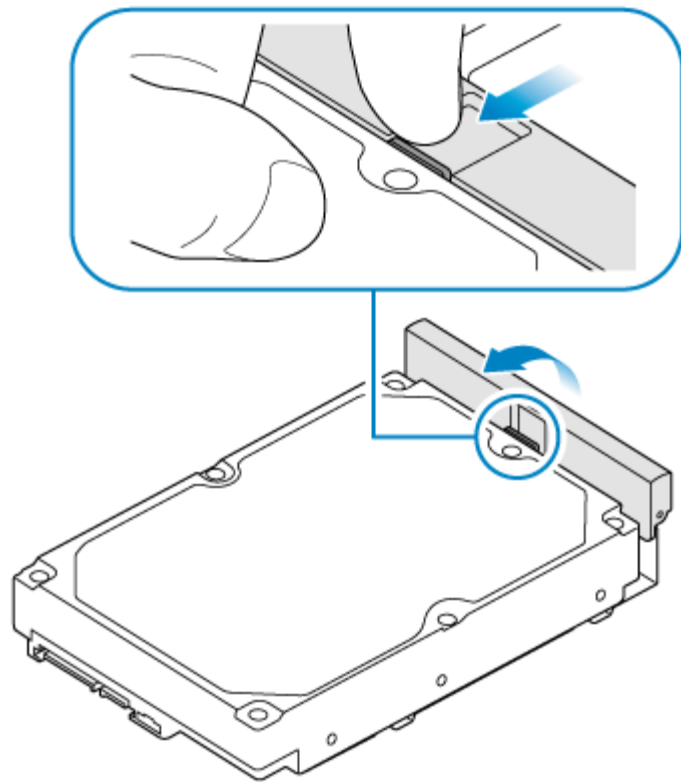

3. Place the disk on the NAS's hard drive guides. Confirm that the disk is correctly aligned on the guides by gently pushing it away from the SATA connection.

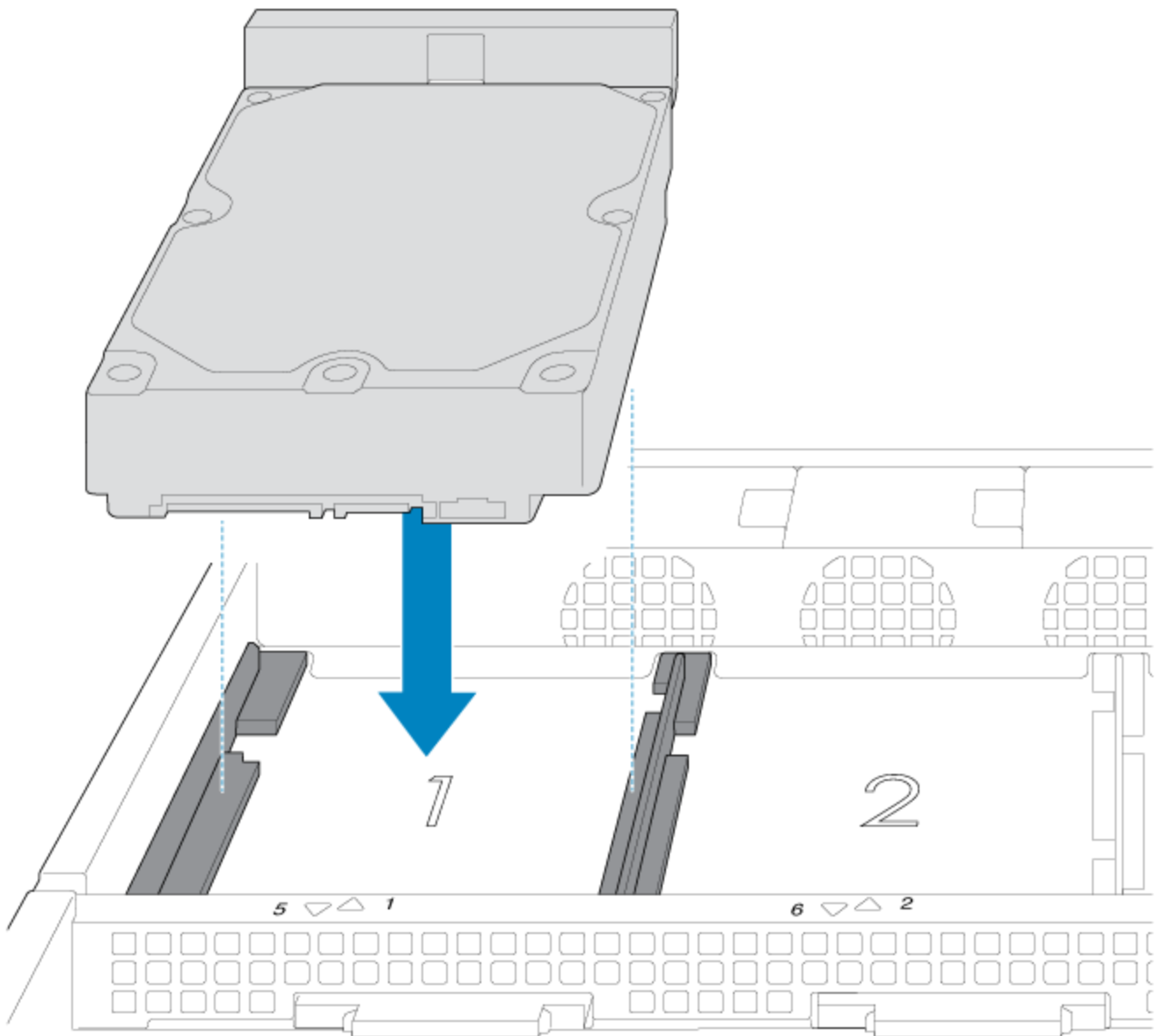

4. Slide the disk into the SATA connection.

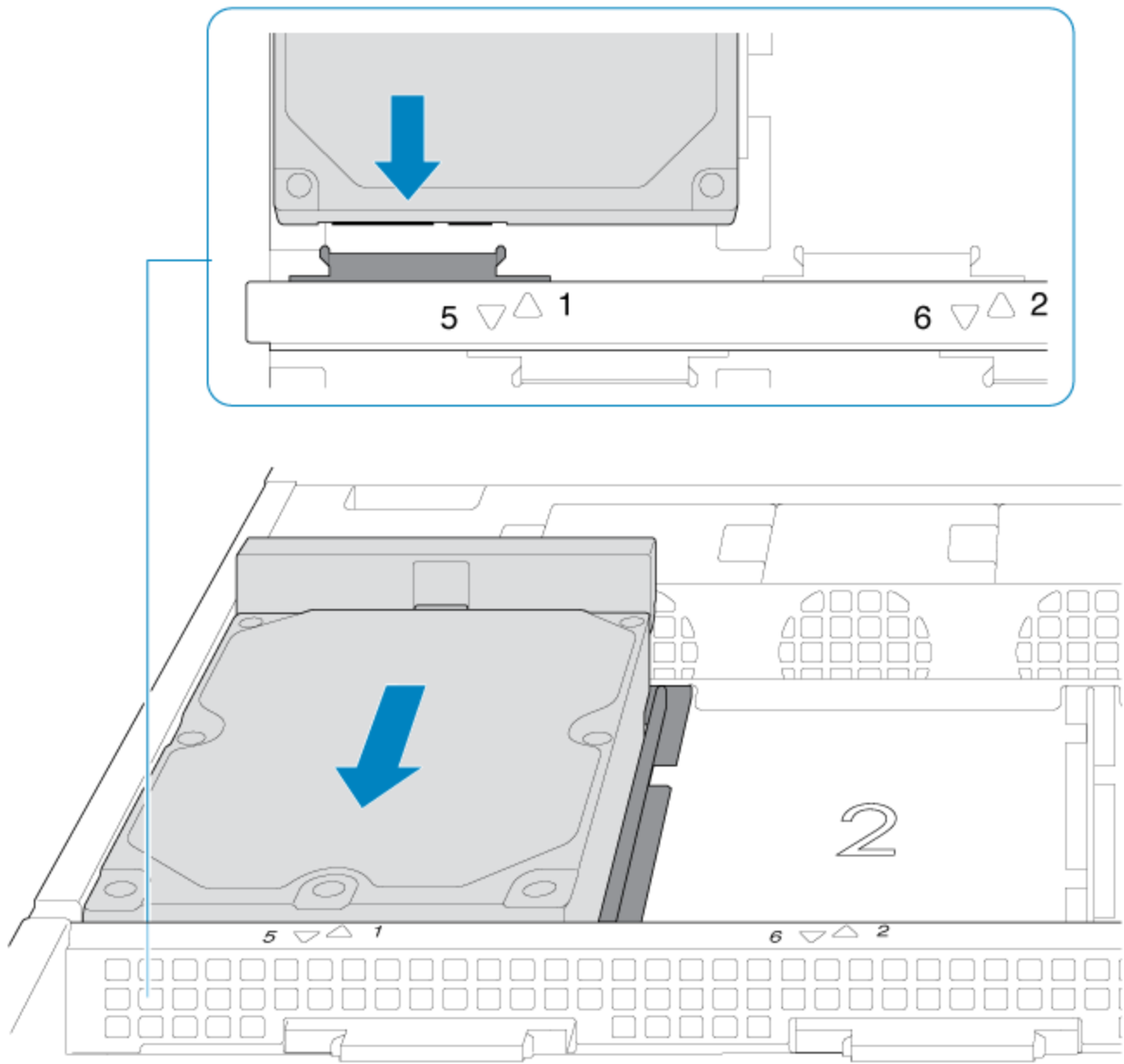

5. Close the disk's latch.

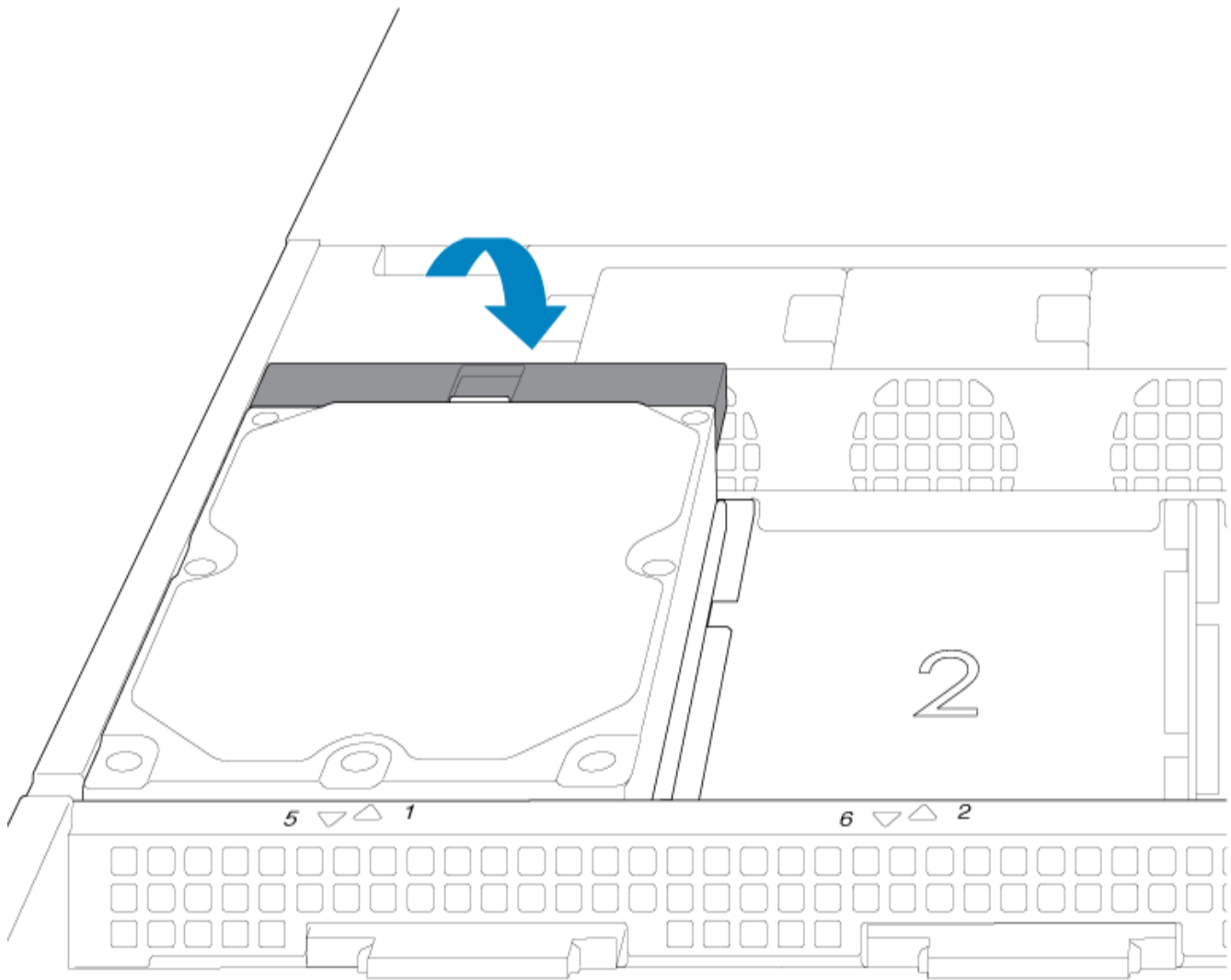

6. Repeat the steps for each disk.
7. Replace the cover and slide the NAS into the rack. To unlock the rails, pull the rail fasteners on each side toward you. Secure the NAS to the rack using the two front screws.

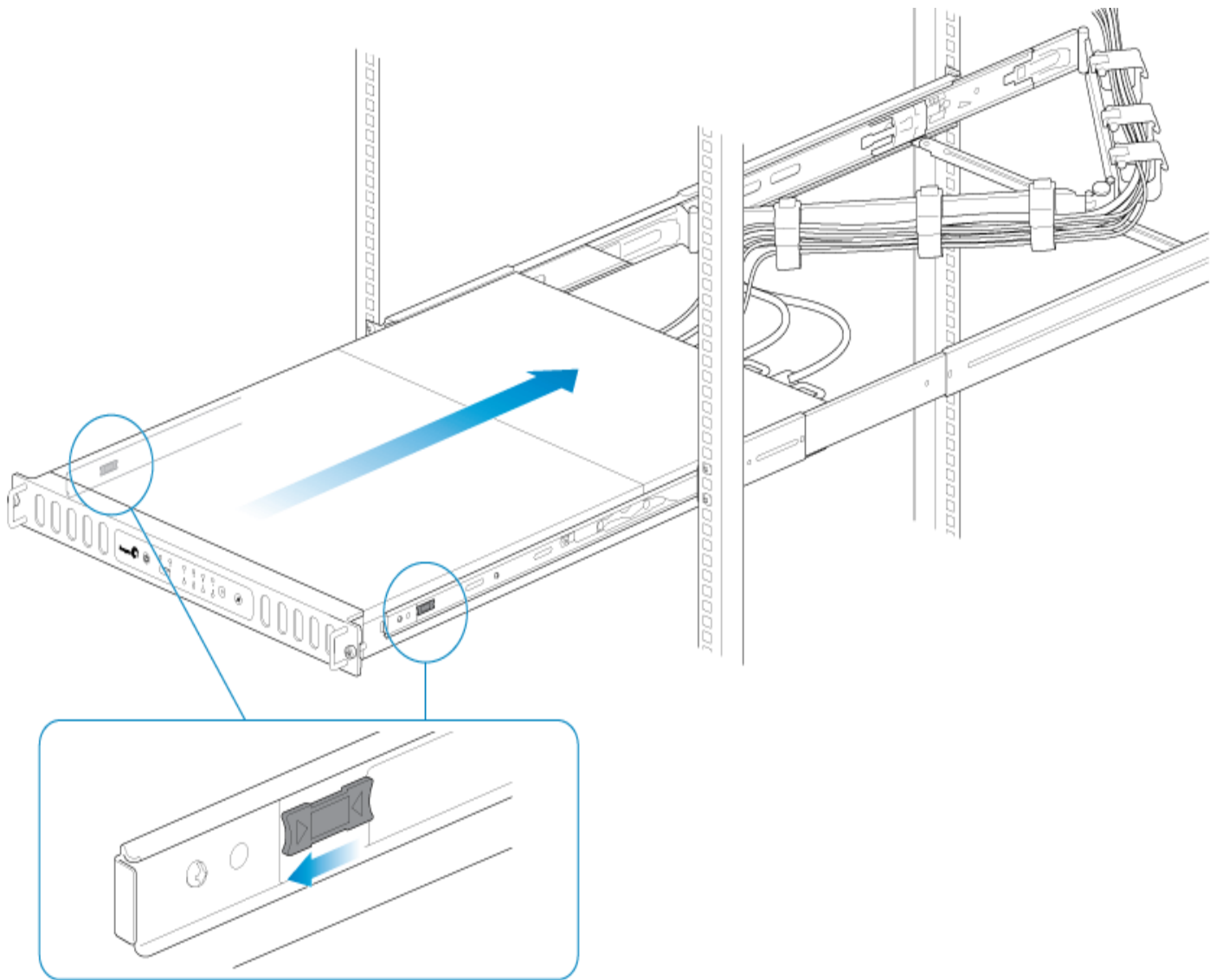

8. Log on to the Seagate 8-bay Rackmount NAS from a workstation on your network to manage the new storage.
9. Rebuild the NAS volume. For details, refer to [Software](#).

Replace a fan

! **Caution:** The fans are hot-swappable and can be replaced when the NAS is powered on. You must use caution when removing a fan. In most instances, the fan will stop rotating once it is removed from its slot. However, **moving parts can cause severe damage to your hands and body.**

i **Important info:** The NAS is temperature controlled via an internal sensor. When removing one of the three fans, the other two will turn faster to maintain the required operational temperature. The faster rotation will be sudden and can become loud. If your NAS fans appear to be louder than normal, confirm that the room's temperature is within operational range (see [Safety Guidelines](#)).

1. Remove the cover as described above.
2. Using your forefinger and thumb, pinch the clips that secure the fan to its slot.

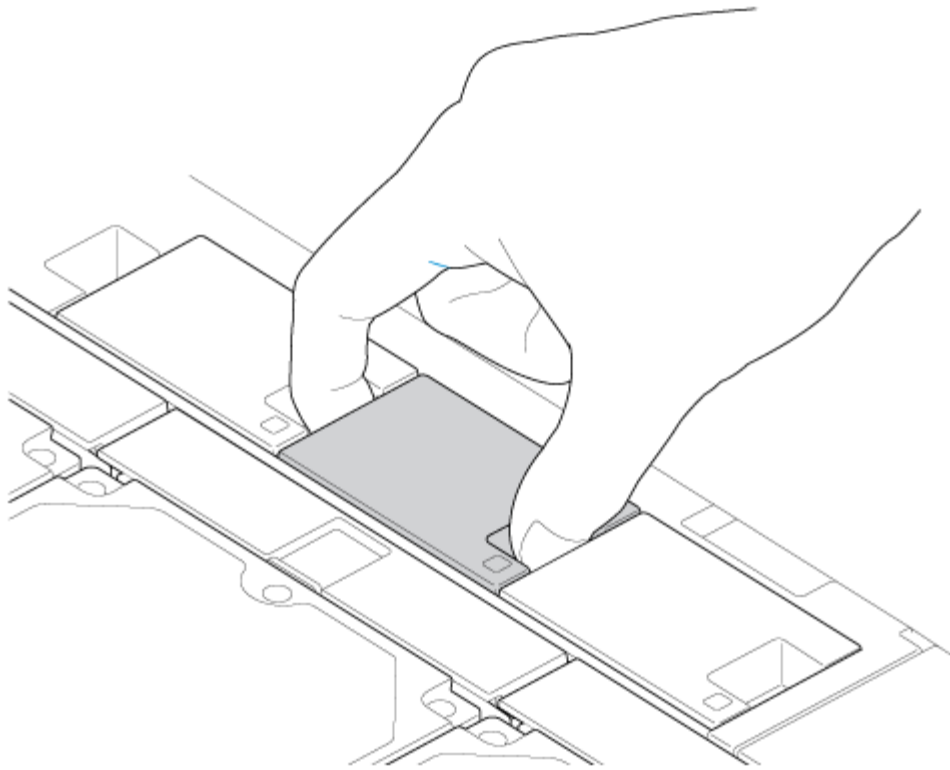

3. Lift the fan from its slot. Show caution when removing the fan since moving parts can cause severe damage. The fan should stop rotating once it is removed from its slot.

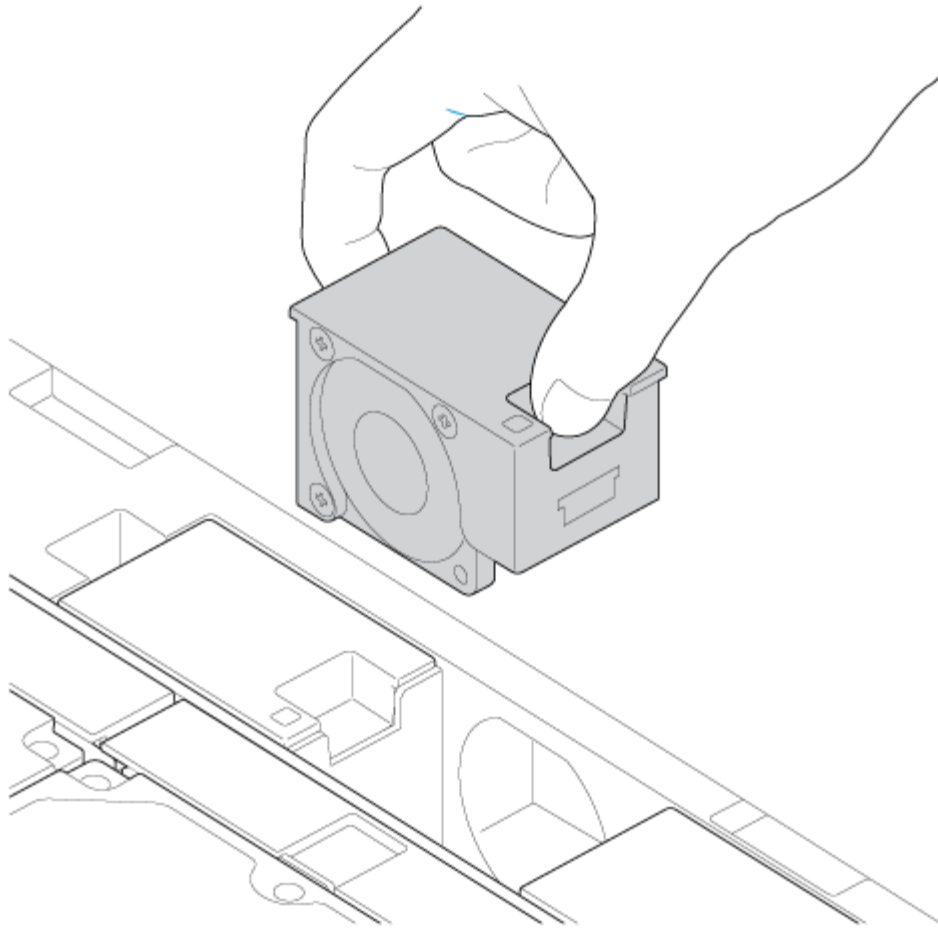

4. Insert the replacement fan into the empty slot.

Rear chassis

Remove the rear cover

1. Power off, unplug the power supplies, then wait for the components to completely cool.
2. Slide the NAS toward you until it locks into position.
3. Remove the two screws on the rear cover.

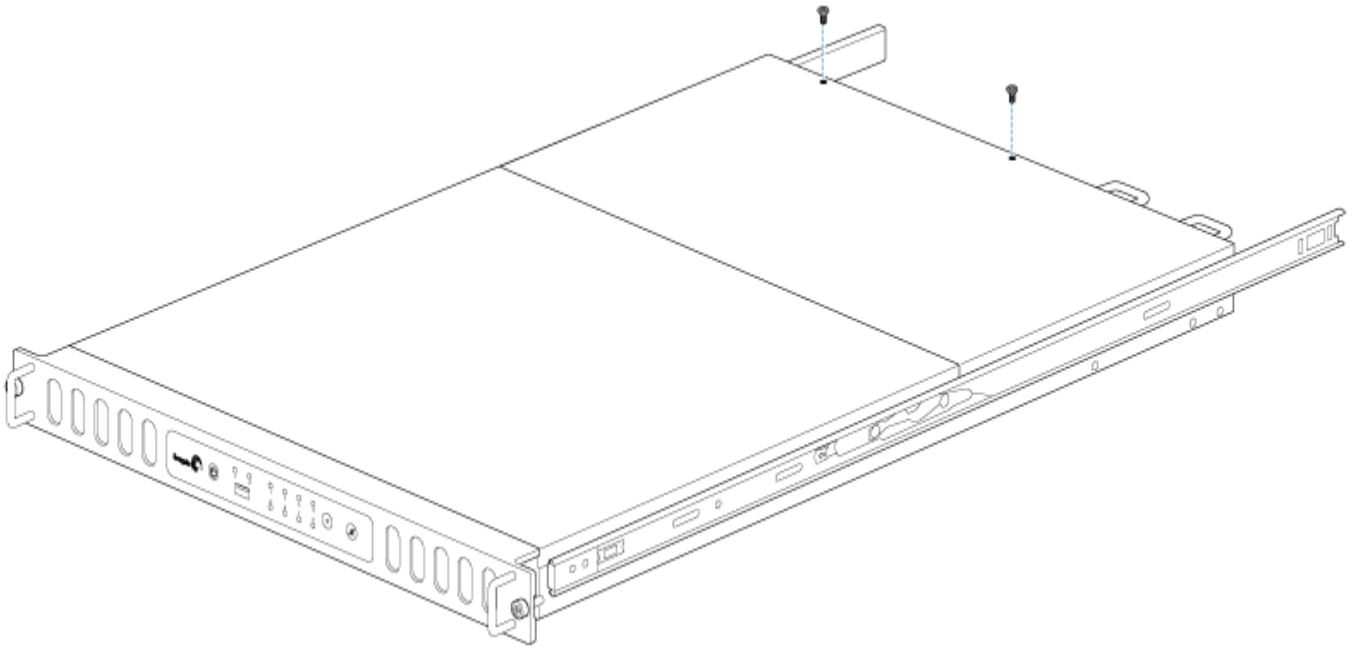

4. Slide the cover toward the rack and remove it from the NAS.

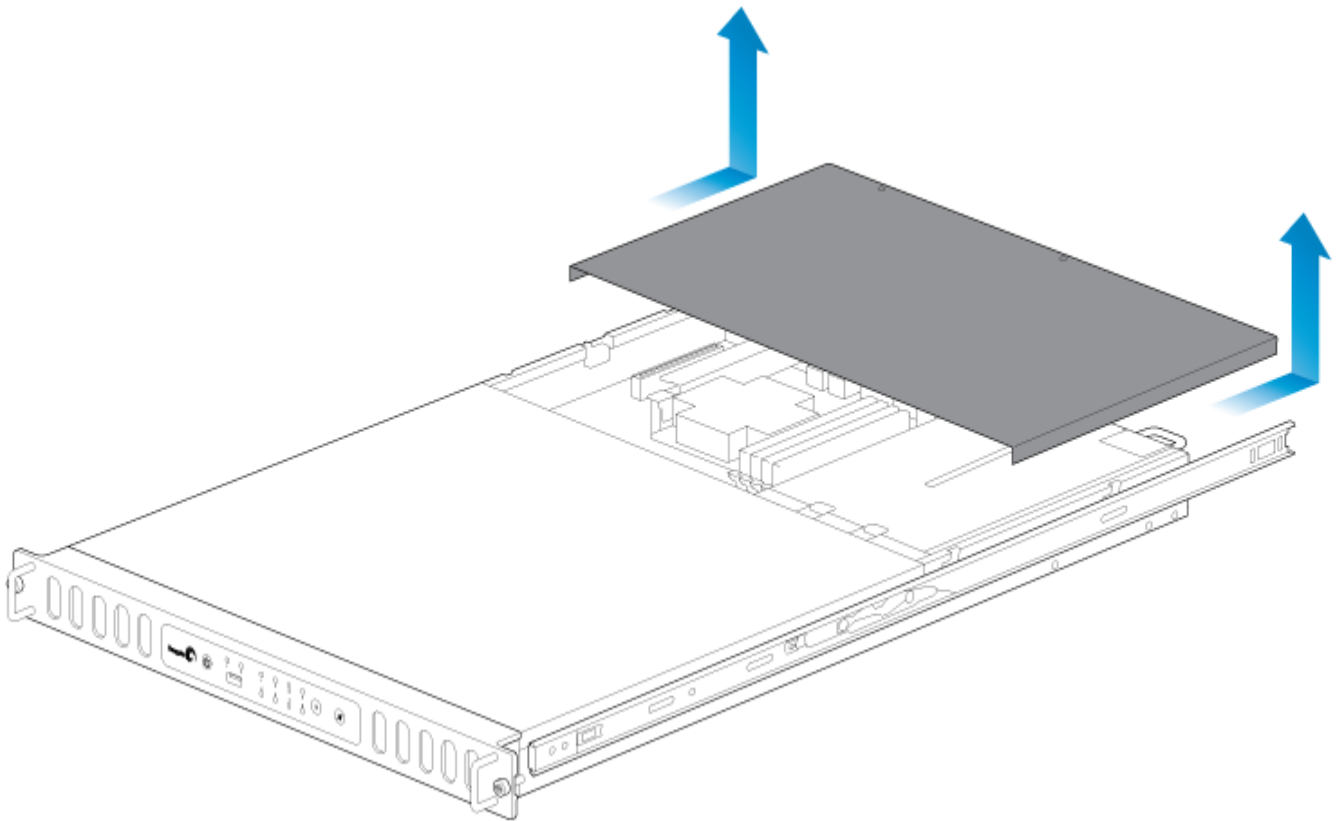

Rear chassis information

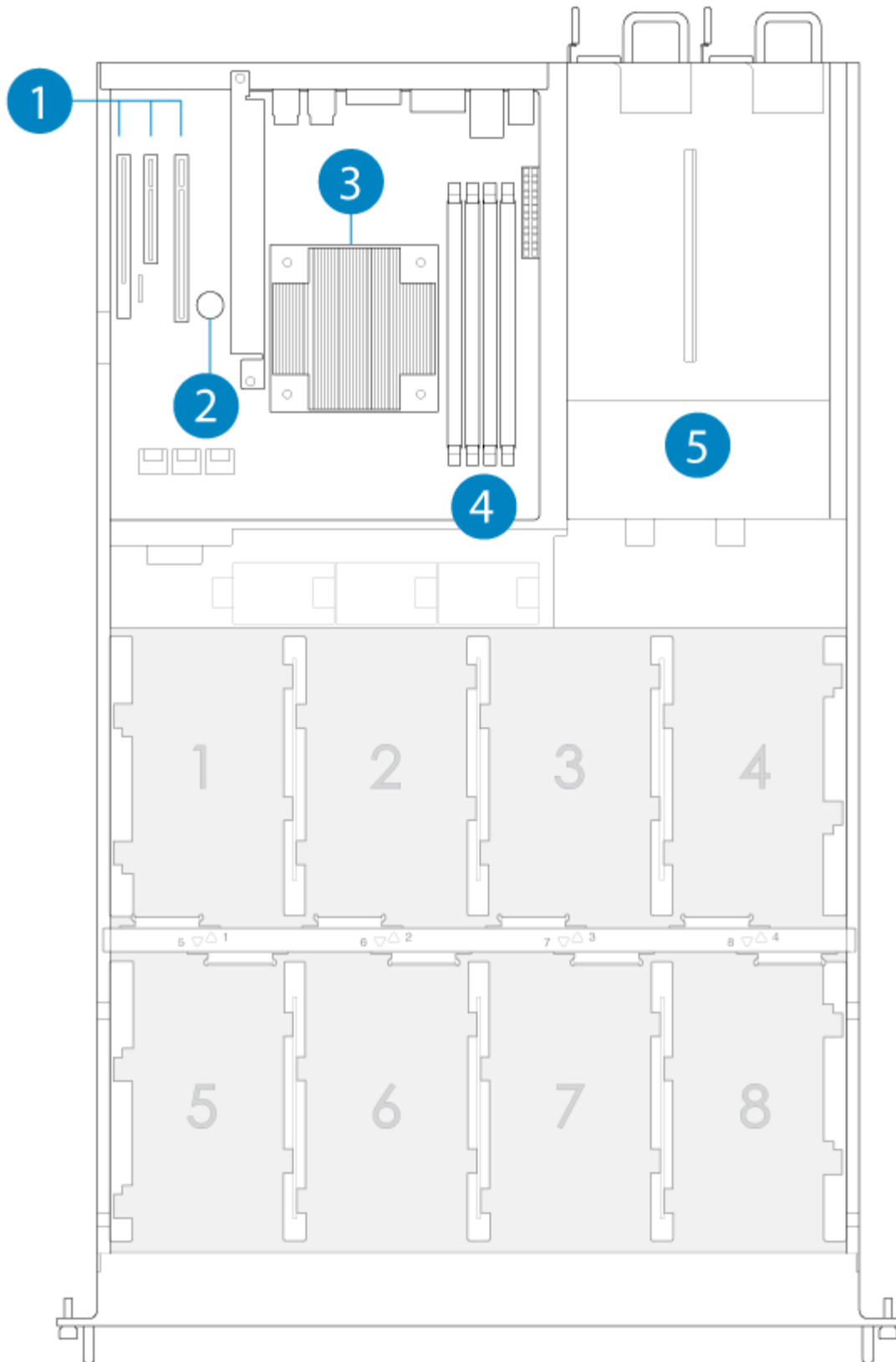

1. PCIe slots
2. Battery
3. Central Processing Unit (CPU)
4. RAM slots
5. Power supplies (x2)

Installed components

The rear chassis is shipped with the following:

1. PCIe: SATA extender (do not remove the SATA extender or add third-party PCIe boards to the NAS)
2. Battery: 3V Lithium Battery (CR2032)
3. CPU: Intel® Ivy Bridge 2.3GHz
4. RAM: 4GB DDR3 DIMM ECC (x1)
5. Power supplies: 100 to 240 VAC, 50 to 60 Hz (x2)

Replace the battery

The battery is located next to the PCIe slots and protected by the extension card support. To remove the extension card support, you will need a Torx screwdriver with a T6 point.

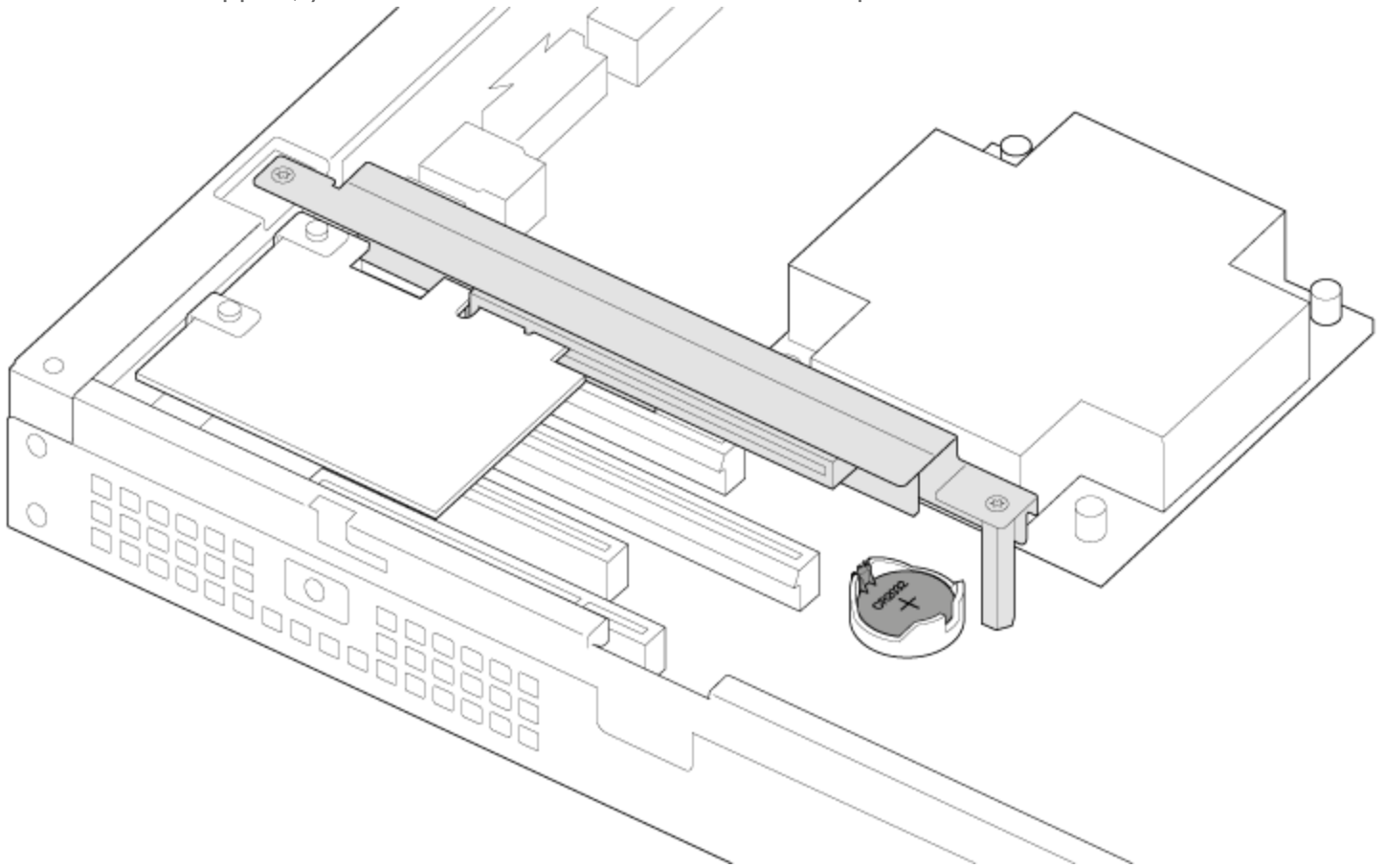

Use caution when replacing the battery. There is a strong risk of explosion if the battery is replaced by an incorrect type.

1. Power off the system, unplug the power supply, and remove the rear cover as described above.
2. Remove the screws from the extension card support.

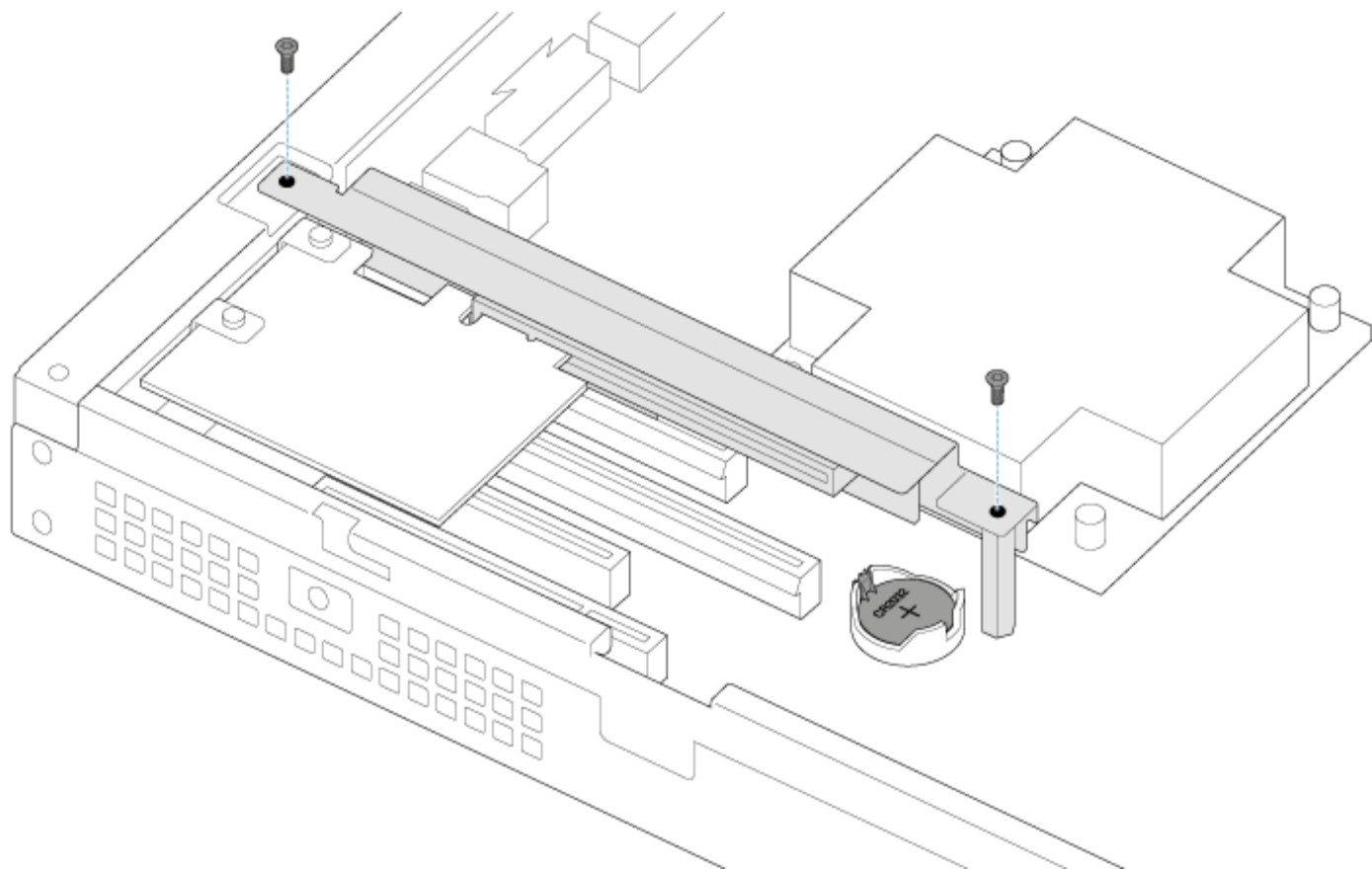

3. Gently unfasten the extension card support from the extension card and remove it to provide access to the battery.

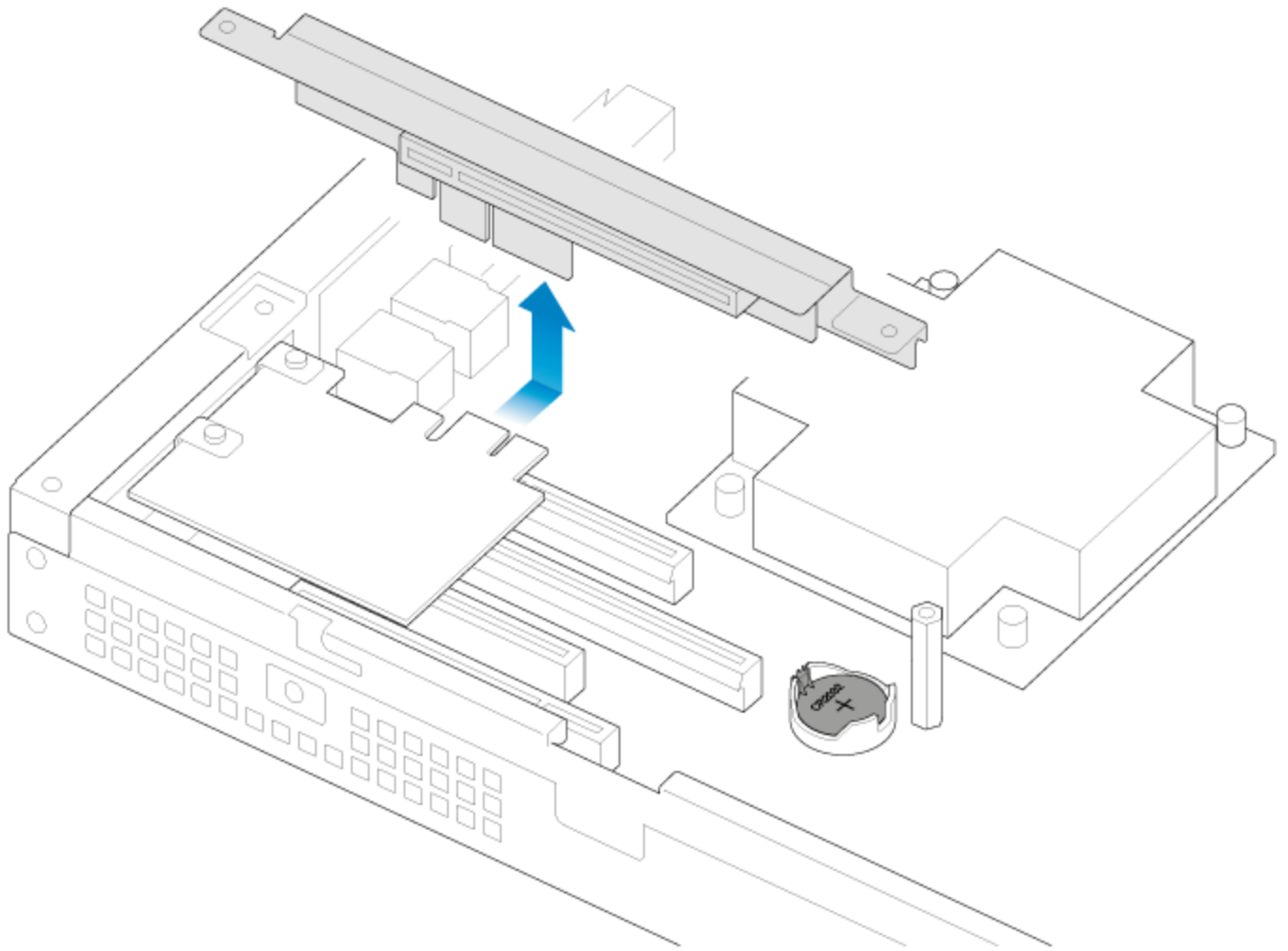

4. Use one hand to press the battery's retaining clip away from the battery and use the other hand to lift the battery from its socket.

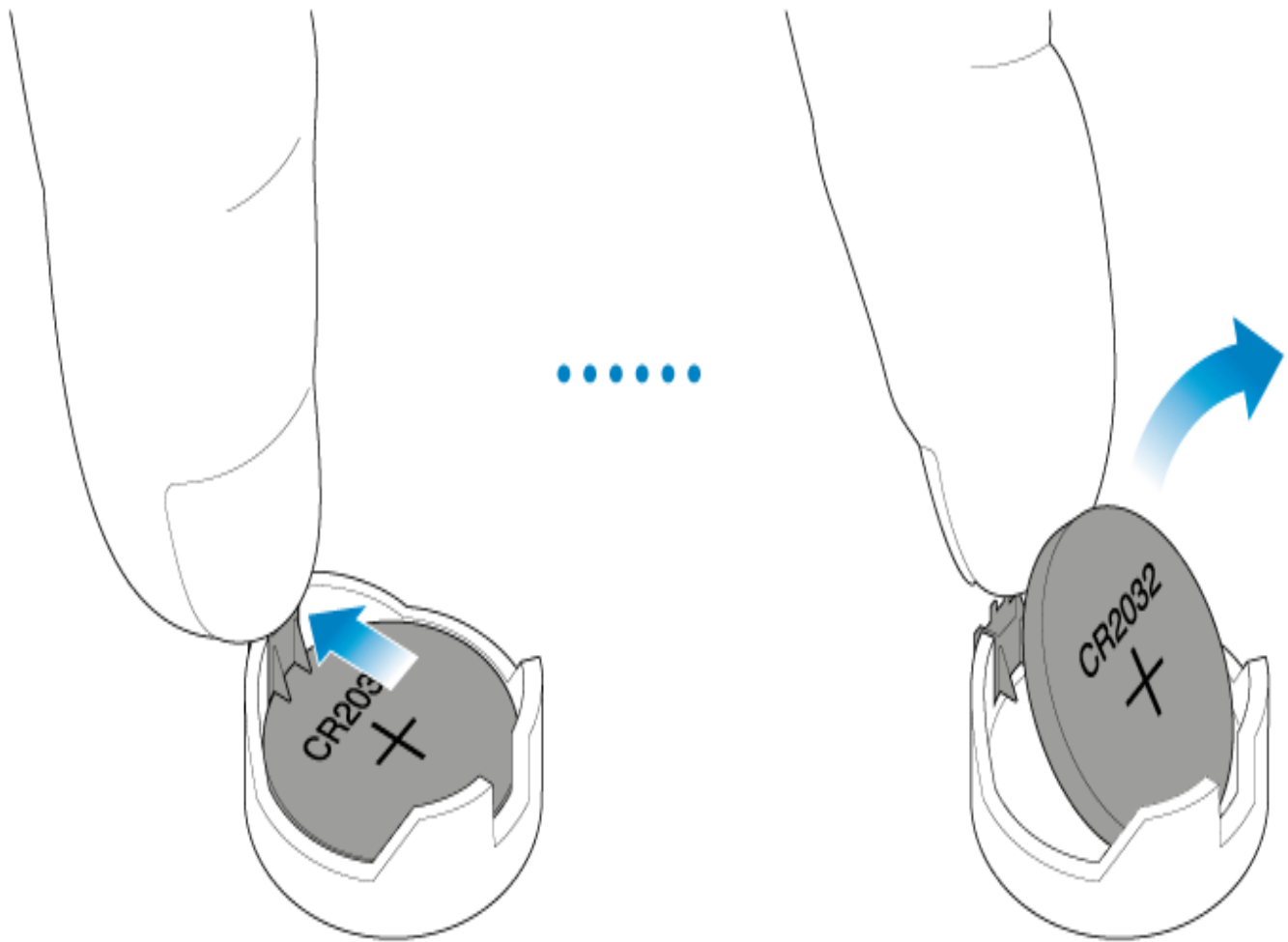

5. Insert the replacement battery into the battery socket.
6. Connect the extension card support to the extension card and fasten its screws.
7. Replace the rear cover and connect the power supply cables.
8. Power on the NAS.

Make certain to dispose of used batteries according to the applicable laws for your region.

RAM

Adding a DIMM (RAM) to an empty slot

1. Power off the NAS, unplug the power supply, and remove the cover as described above.
2. Locate an empty DIMM slot and press its retaining clips outward.

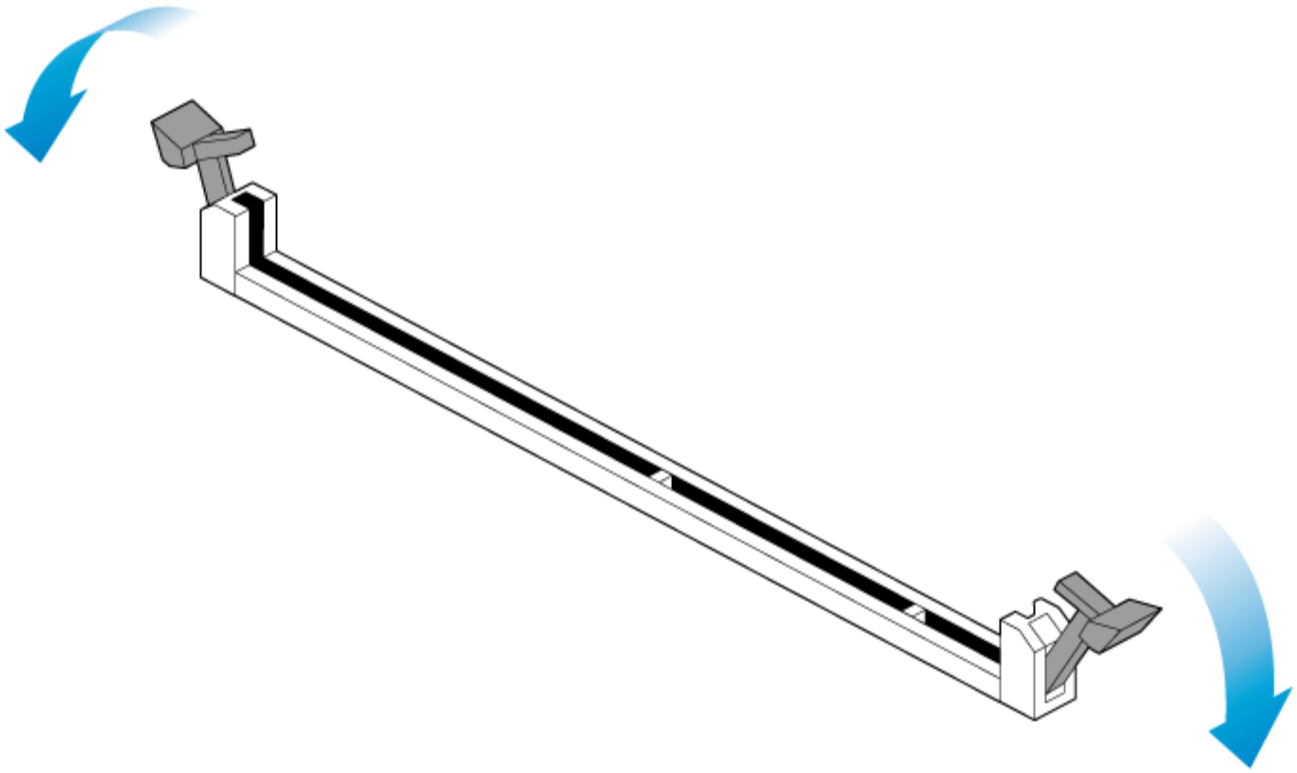

3. Align the DIMM on the slot's socket. Make certain that the edge of the DIMM's notch matches the key for the socket.

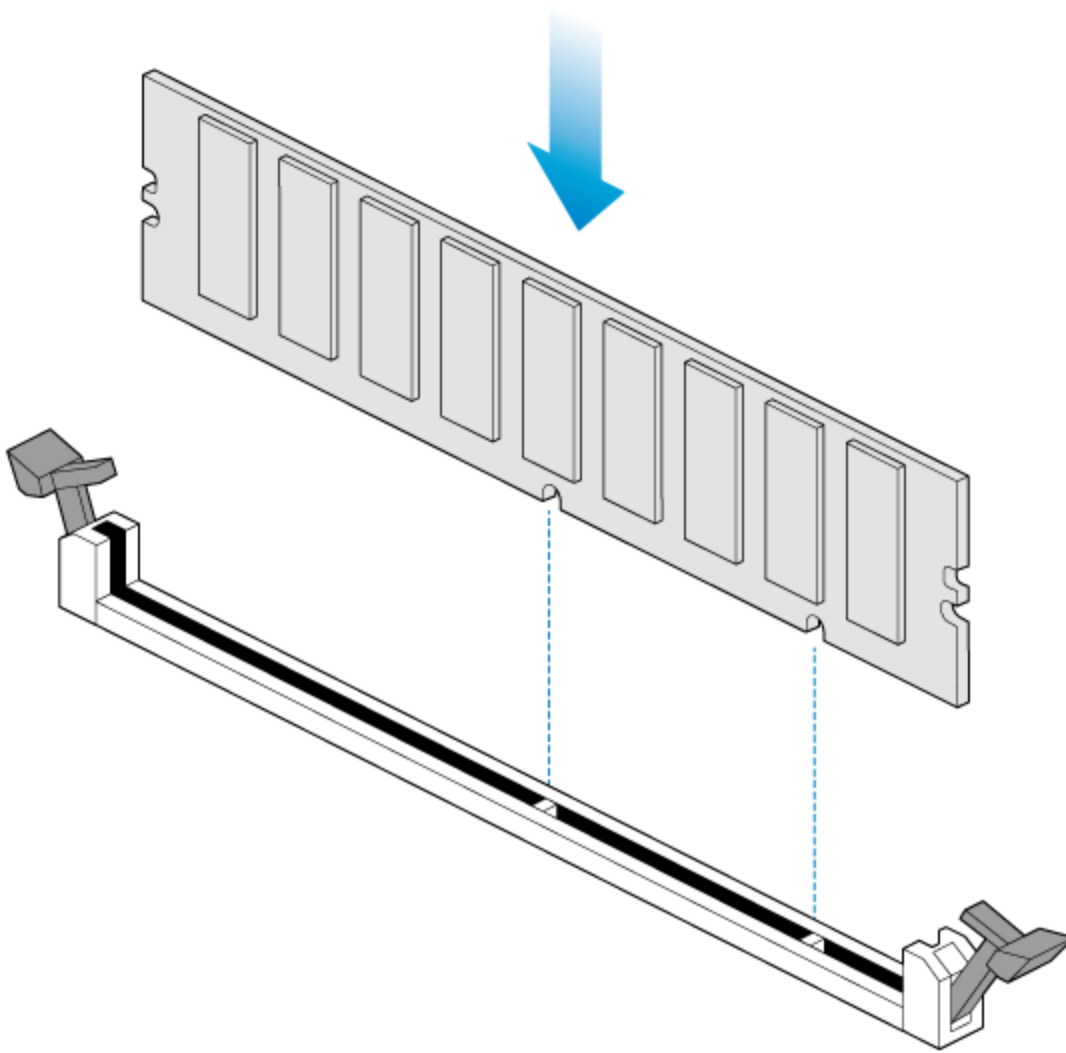

4. Hold the DIMM on both ends and carefully insert it into the socket. The DIMM is properly inserted when you cannot push it further and the retaining clips snap into place.

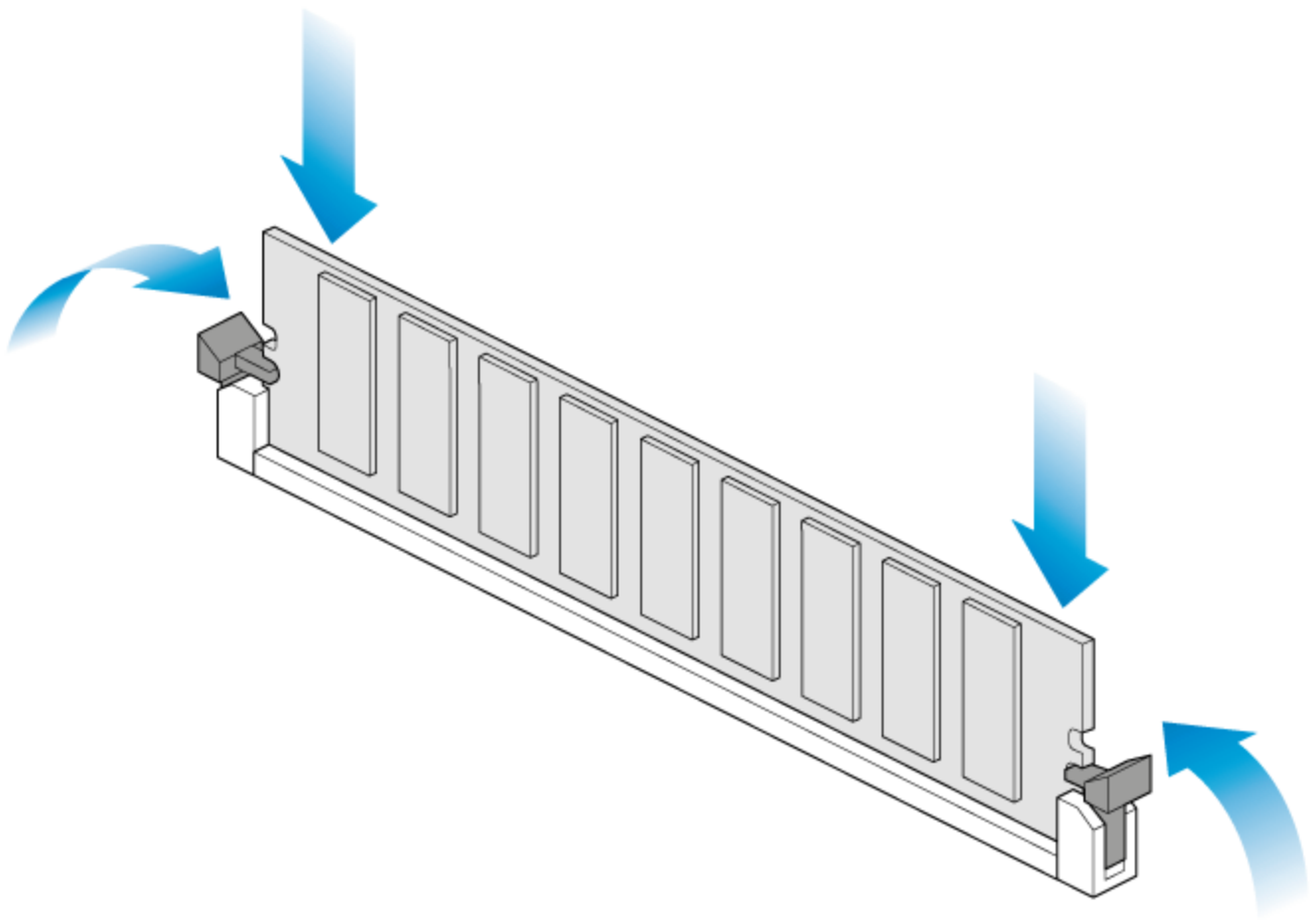

i **Important info:** Always insert the DIMM vertically to avoid damaging the notch. You may have to apply a limited amount of force on the DIMM's edges when pushing it into the socket.

Remove a DIMM (RAM)

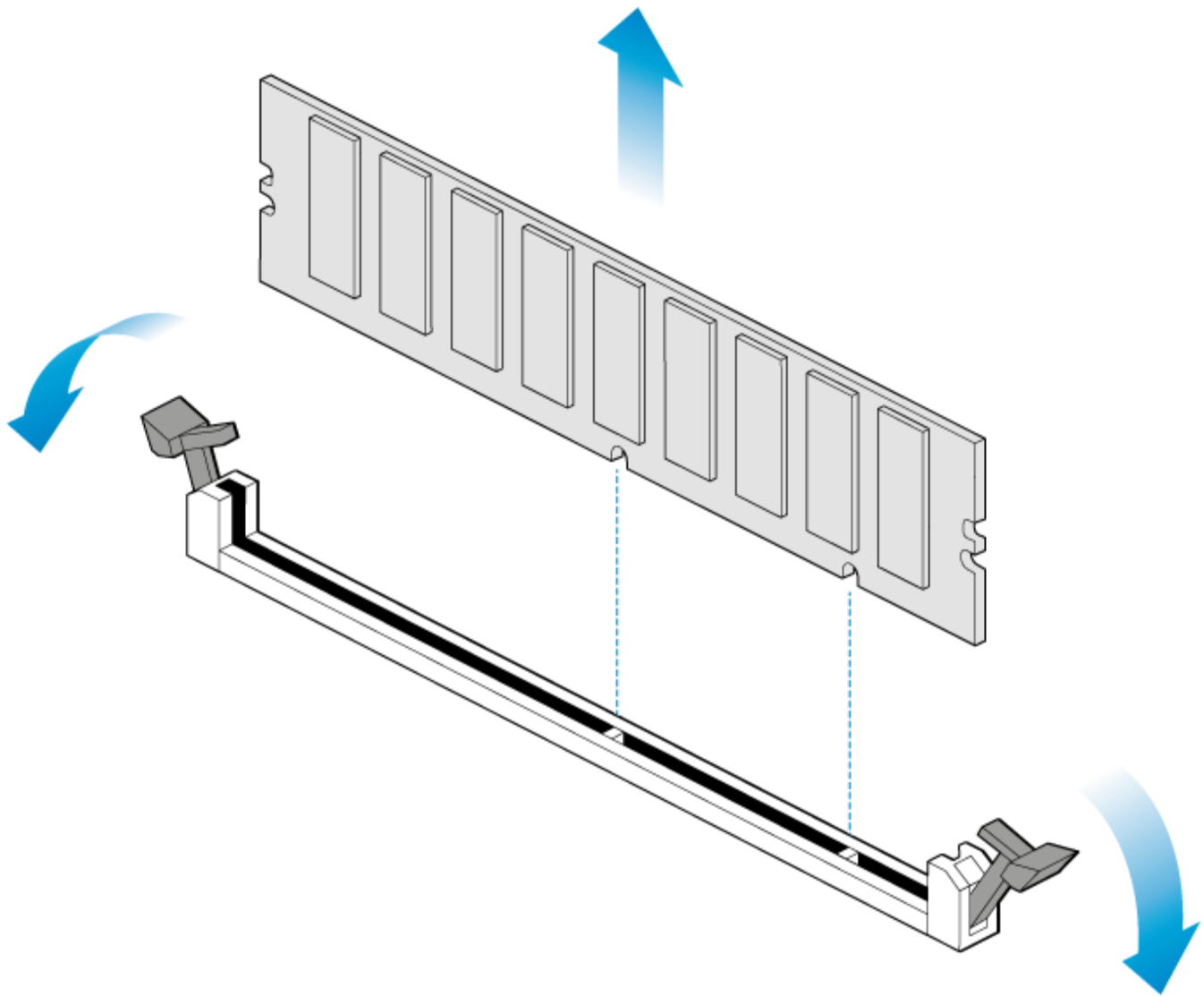

1. Power off the NAS, unplug the power supply, and remove the cover as described above.
2. Press the retaining clips outward to unlock the DIMM from its socket.
3. Hold the DIMM on its two ends and lift it from the socket.

Blinking purple LED: Confirm the connection

A blinking purple LED indicates that the backplane and motherboard cannot communicate. Follow the steps below to determine if the cable is properly seated:

1. Power off the 8-bay Rackmount NAS.
2. Remove the rear cover.
3. Confirm that the communication cable between the backplane and motherboard is firmly connected. The cable is located directly in front of the PCIe SATA Extender.

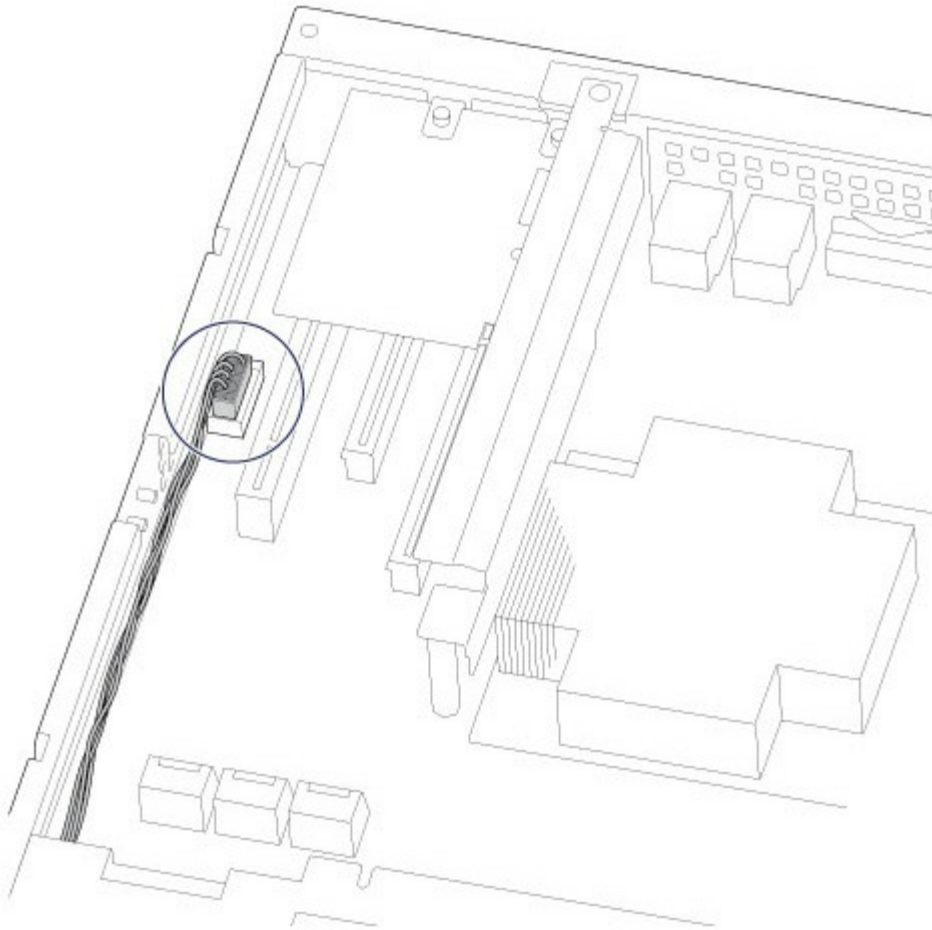

4. If the connection is loose, try to fix it into place.
5. Install the rear cover.
6. Power on the 8-bay Rackmount NAS.

If the LED continues to blink purple, contact Seagate support.

Getting Help

If you are having issues with your product, first consult this user manual and the troubleshooting topics below. If the problem persists, refer to:

- The Seagate NAS OS User Manual
- [Seagate Technical Support](#)
- [Warranty rights and responsibilities](#)



Note: Seagate is dedicated to providing high quality products that enrich the lives of our customers. To help Seagate offer the best customer support, we encourage you to create an account and register your product at [Seagate Product Registration](#). You can give us important feedback as well as receive updated information on your Seagate device.

Troubleshooting topics

The 8-bay Rackmount NAS will not turn on.

Q: Can you confirm that the NAS is receiving power?

A: Make sure the power cord is properly connected, then push the power button until the Status LED turns ON.

Q: Have you connected a USB storage device?

A: The NAS may be attempting to boot from it. Unplug the device and retry to reboot the system.

Q: Does the motherboard battery need to be replaced?

A: A non-functioning motherboard battery could prevent the system from booting. Contact Seagate support for confirmation and help.

Q: Is there a problem with one or both power supply units?

A: Connect a monitor, mouse, and keyboard, and turn your product on. If you don't see anything on the monitor, that means that the problem may result from the NAS's power supply units. Your NAS has redundant power supplies that allow for one to fail. Contact Seagate support if you believe that one or both power supplies have failed. In the rare case in which both power supplies fail at the same time, you may be asked to send NAS to Seagate for review.

The 8-bay Rackmount NAS turns off when I connect a USB device.

Q: Have you connected more than three bus-powered USB devices or is one of your devices drawing an inordinate amount of power?

A: Connect no more than three bus-powered USB devices and/or make sure that none of the devices is drawing an inordinate amount of power.

Q: Did the product turn off as soon as the USB device and the 8-bay Rackmount NAS's USB port came into contact?

A: The USB device may have caused a short circuit. Unplug any USB devices you have connected since the failure and reboot the product.