



# Toolkit

User Manual

---



**Click here to access an up-to-date online version**  
of this document. You will also find the most recent content as well as expandable illustrations, easier navigation, and search capability.

# Contents

<b>1 Getting Started with Toolkit</b>	<b>5</b>
System requirements	6
Download and install Toolkit	6
Open Toolkit	7
Main menu	7
<b>2 Mirror Activity</b>	<b>10</b>
Mirror folder locations	10
Create a mirror plan	11
• Quick setup	11
• Custom setup	11
• Adding files to mirror folders	11
Pause/resume a mirror plan	11
Edit a mirror plan	12
Delete a mirror plan	12
View report	12
Toolkit Mirror FAQ	13
<b>3 Backup Activity (Windows Only)</b>	<b>14</b>
File types and procedure	14
• Locating backed up files	14
• Viewing archived files	14
Set up a quick backup	15
Create a custom backup plan	15
Edit a backup plan	15
Define your backup plan	16
• Step 1: Select content	16
• Basic	16
• Advanced	16
• Step 2: Select the destination drive	17
• Step 3: Schedule backups	17
Pause/resume a backup plan	17
Delete a backup plan	18
Restore files	18
View report	18
Toolkit Backup FAQ	19
<b>4 Restore Activity (Windows Only)</b>	<b>20</b>
<b>5 Sync Plus Activity</b>	<b>21</b>
Set up a quick sync	21

Create a custom Sync Plus plan .....	22
Pause/resume a Sync Plus plan .....	23
View synced folders and archive .....	23
Edit a Sync Plus plan .....	23
Delete a Sync Plus plan .....	23
Restore files .....	23
Files and folders excluded from syncing .....	24

## **6 Seagate Secure .....** **25**

Enable security with Toolkit .....	25
• Optional password reset key setup .....	27
Unlock the drive .....	27
• Entering your password with Toolkit .....	27
• Entering your password with the Unlock Drive app .....	28
• Exceeding the maximum number of failed password attempts .....	28
Lock the drive .....	29
Change your password .....	29
Set up a password reset key .....	29
• Requirements .....	30
• Password reset key setup after security is enabled .....	30
Use a password reset key .....	31
Trusted computers .....	31
• Removing trusted computer status .....	32
Disable security .....	32
Re-enable security .....	32
Multi-user access .....	33
• Editing the second user .....	35
• Disabling the second user .....	35
• Deleting the second user .....	35
Crypto-erase the drive .....	35
Reset the drive to factory settings .....	36

## **7 Import .....** **38**

Install Import .....	38
Import from memory cards .....	38
• Activate/deactivate memory card imports .....	39
• Activate/deactivate incremental imports for memory cards .....	39
Import from USB devices .....	39
• Activate/deactivate import prompts for USB devices .....	40
Location of imported files .....	40
Folder naming convention .....	40
Toolkit Import FAQ .....	40
• Q: Does Import delete the content on my memory card after it has finished importing content to my drive? .....	40
• Q: Can I use Import with an external card reader? .....	41

## **8 RAID Setup .....** **42**

Additional resources from LaCie RAID Manager .....	42
RAID explained .....	42
• RAID and data security .....	43
Setting RAID level and formatting with Toolkit .....	44

## 9 RGB and Status LED Management ..... 45

Disable/enable the status LED .....	45
Edit RGB illumination patterns .....	46
• Access RGB activity .....	46
• RGB illumination settings .....	46
• Razer Chroma via Razer Synapse 3 app (Windows only) .....	46
• Requirements for Razer Chroma .....	47
• Use Razer Chroma .....	47
• FireCuda RGB app .....	47
• Edit LED settings .....	47
• Select a pattern .....	48
• Select an animation .....	48
• Preview selected pattern/animation .....	50
• Timing controls .....	51
• Change colours .....	51
• Single colour preset animations .....	51
• Single colour and rainbow custom animations .....	52
• Change global settings .....	53

## 10 Settings ..... 54

Toolkit app settings .....	54
Import settings .....	54
Toolkit updates .....	55
About .....	55

# Getting Started with Toolkit

Toolkit helps you get the most out of your storage solution with easy-to-use tools for backing up your files, managing security and much more. Toolkit activities and features include:



**Protecting your data with automated backups.** Create folders on your drive that mirror folders on your computer, so your files are always available in both places.



**Managing security for Seagate and LaCie self-encrypting drives.** Use Toolkit to enable security, create a password, and rest easy knowing your data is protected with Seagate Secure AES 256-bit encryption technology.



**Setting up RAID.** Toolkit helps you easily configure the initial RAID level and formatting for compatible Seagate and LaCie dual-drive devices.



**Quickly importing files from memory cards.** Simply insert a memory card into the drive's integrated card reader and Toolkit automatically copies your files to the drive — no need to open folders and drag files.



Some Toolkit activities and features are available only for supported Seagate and LaCie drives. See the chapters in this user manual to learn more about the drives supported by a given activity or feature.

## System requirements

Go to [Operating System Requirements for Seagate Hardware & Software](#).

## Download and install Toolkit



Your computer must be connected to the internet to install and run Toolkit.

1. Click to open the [LaCie Toolkit Support page](#).
2. Scroll down to the Downloads section.
  - **Mac** – Click on the [LaCie Toolkit for macOS](#) link.
  - **Windows** – Click on the [LaCie Toolkit for Windows](#) link.
3. Using a file manager such as Finder or File Explorer, go to the folder where you receive downloads.

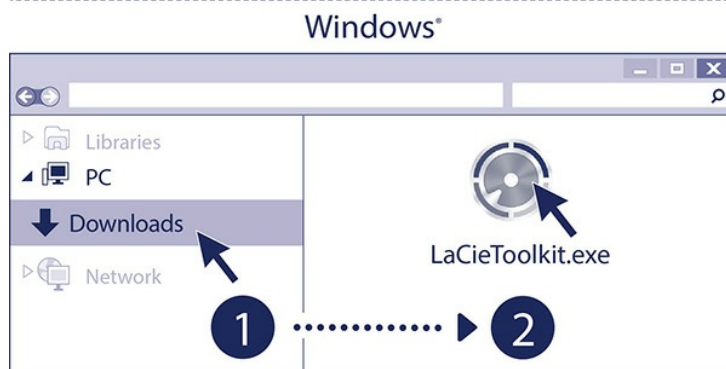
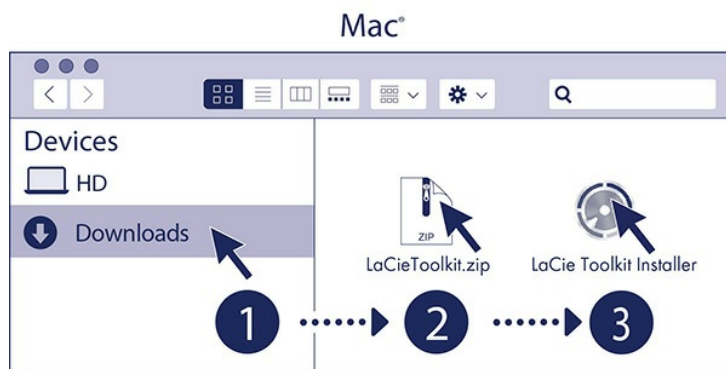

- **Mac** – Open the [LaCieToolkit.zip](#) file. Click on the [LaCie Toolkit Installer](#) to launch the application.
- **Windows** – Click on the [LaCieToolkit.exe](#) file to launch the application.

# Open Toolkit

Open Toolkit using any of the following methods:



Mac

- Click in the Spotlight bar and type **Toolkit**, then select the app.
- Using Finder, open your Applications folder and double-click **Toolkit**.



Windows

- Double-click the Toolkit icon on your desktop. For easy access, you can add the Toolkit icon to your taskbar.
- Click in the Search Windows bar and type **Toolkit**, then select the app.
- Click on the Start menu and select **Toolkit** from the menu.

## Main menu

When you open Toolkit, the Main Menu appears.

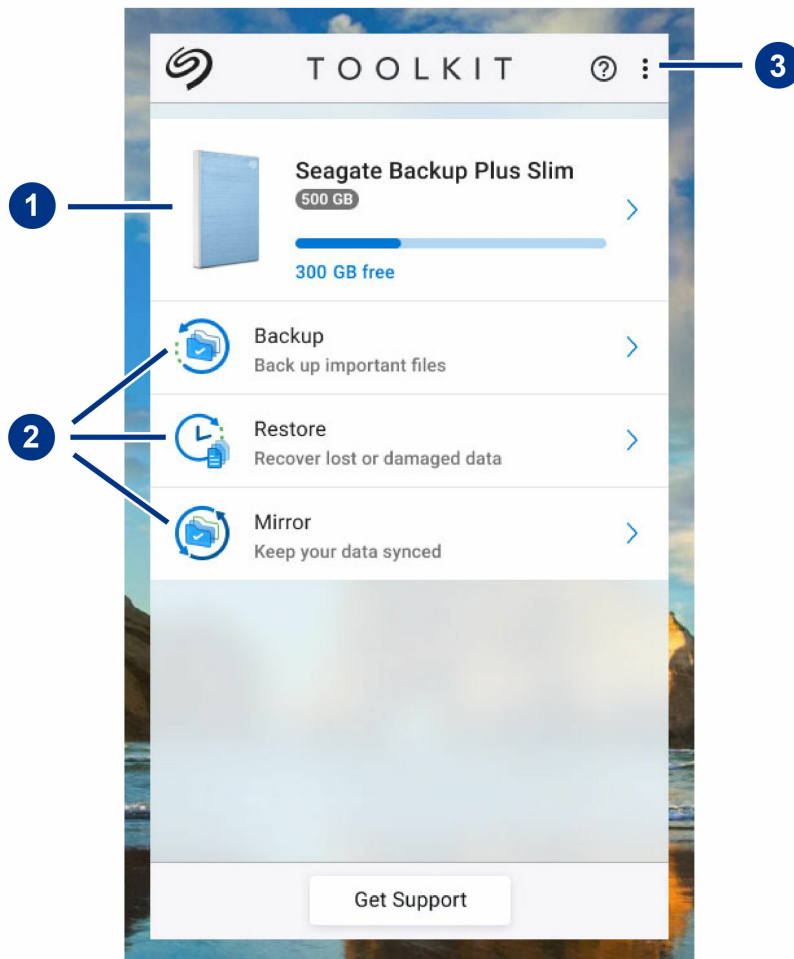

1. **Drives** – Click to view details about the device.
2. **Activities** – Click to set up or edit an activity.

3. **More** – Click on the icon to change settings or quit Toolkit.

Your Seagate or LaCie model determines which activities appear in Toolkit. Depending on your drive, you may see the following activities (as shown in the image above):

- [Mirror](#)
- [Backup \(Windows only\)](#)
- [Restore \(Windows only\)](#)

Some Seagate and LaCie models support [Sync Plus](#) instead of Backup/Restore/Mirror:

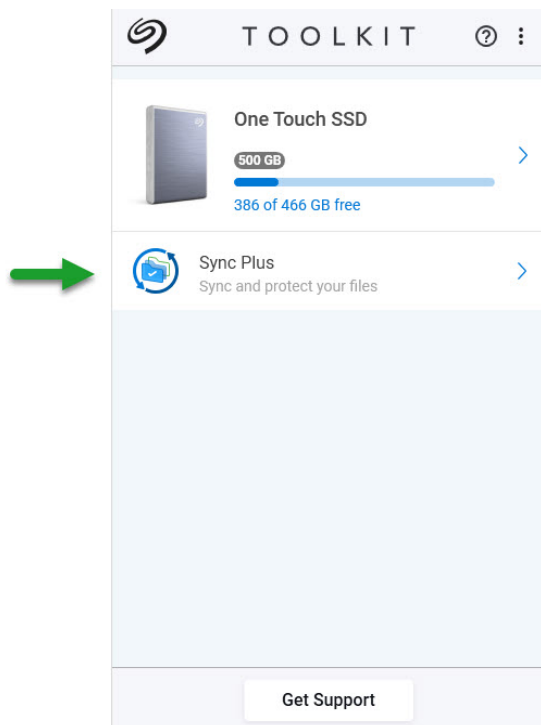

Seagate and LaCie self-encrypting drives (SED) also include the [Seagate Secure](#) activity:



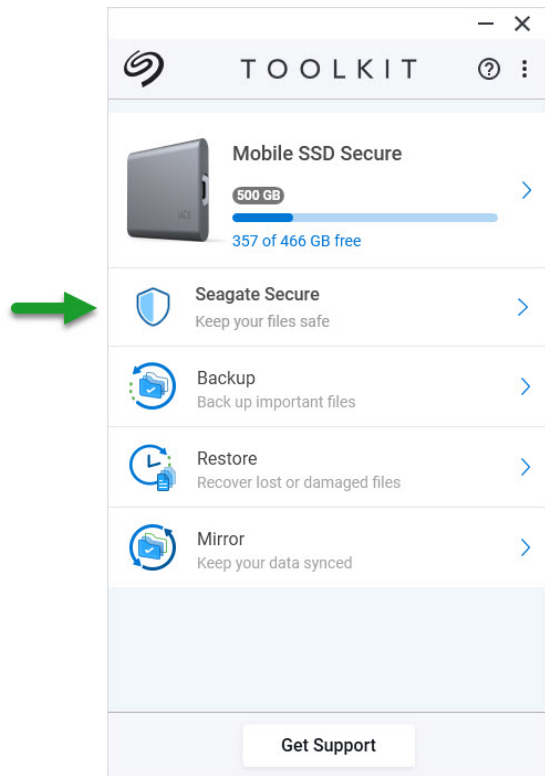

Drives with customisable LEDs include the [RGB](#) activity:

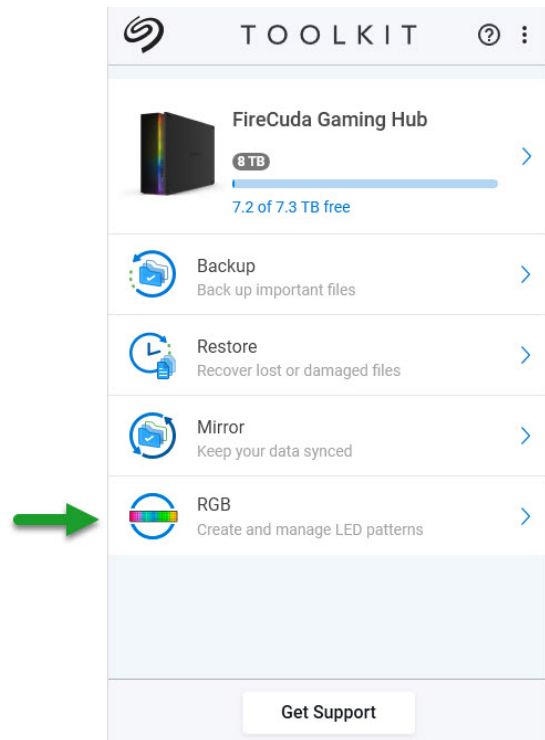

# Mirror Activity



The Mirror activity lets you create a Mirror folder on your PC or Mac that is synced to your storage device. Whenever you add, edit, or delete files in one folder, Toolkit automatically updates the other folder with your changes.

## Mirror folder locations

When setting up mirror folders, you can specify the location of the mirror folder on your PC or Mac. If a location is not specified, the mirror folder is placed at the root of the user folder.

Toolkit creates a corresponding mirror folder on your external drive. On Windows PCs, the mirror folder is located at:

`X:\Toolkit\Mirror\`



X indicates the drive letter assigned to your external drive by your computer. Your drive letter may be different and may change depending on the number of drives connected to your computer.

Toolkit creates the mirror folder at the following location:

`Name\Toolkit\Mirror\`



**Name** indicates the name assigned to the external drive.

# Create a mirror plan

## Quick setup

Toolkit can quickly set up a mirror folder in your computer's user folder.

1. Open Toolkit.
2. On the Main Menu, click on the [Mirror](#) activity.
3. Click [Mirror Now](#).

Toolkit performs the following actions:

- Adds a folder named "Mirror" in your user folder on the computer.
- Adds a folder named "Mirror" to your storage device. The default location is in the Toolkit folder.

## Custom setup

A custom setup lets you choose the location of the mirror folder on your computer.

1. Open Toolkit.
2. On the Main Menu, click on the [Mirror](#) activity.
3. Click [Custom](#).
4. Click on the [Mirror to...](#) card.
5. Select a location on your computer for the mirror folder.
6. Click [Create](#).

Toolkit performs the following actions:

- Adds a folder named "Mirror" to the selected location on your computer.
- Adds a folder named "Mirror" to your storage device. The default location is in the Toolkit folder.

## Adding files to mirror folders

To add content, drag files to either Mirror folder. Whenever you add, edit, or delete files in one Mirror folder, Toolkit automatically updates the other Mirror folder with your changes.

**!** The Mirror folders must each be named "Mirror" in order to sync. Do not rename the folders.

## Pause/resume a mirror plan

1. Open Toolkit.
2. On the Main Menu, click on the [Mirror](#) activity.

3. Click on the More icon (  ) and select [Pause](#).

To resume the Mirror plan, click on the More icon (  ) and select [Resume](#).

## Edit a mirror plan

1. On the Main Menu, click on the [Mirror](#) activity.
2. Click on More icon (  ) and select [Edit](#).
3. Select a new location for the Mirror folder on your computer.
4. Click [Create](#).

The new Mirror folder is now synced with the Mirror folder on your storage device.



When Toolkit creates the new Mirror folder, it does not delete the previous folder. The previous folder is no longer synced with your storage device and can be deleted.

## Delete a mirror plan

1. On the Main Menu, click on the [Mirror](#) activity.
2. Click on the More icon (  ) and select [Delete](#).
3. Click [OK](#) to confirm.



Toolkit deletes the mirror plan but does not remove the Mirror folder on your computer or your storage device. The contents of the folders are also preserved.

## View report

You can review a report of mirror activity. The report lists files that were not synced, and includes details on the cause as well as file paths on the host computer and backup drive.

**Mirror files to Backup Plus on 8/29/19, 1:44 PM**Result Summary: **12 of 12 files**

Result	Host Path	Size	Drive Path
✓ Synced	📁 Mirror	30 KB	Backup Plus/Toolkit/Mirror
⚠ Skipped, system file	📁 Icon	-	
⚠ Skipped, system file	📁 .DS_Store	-	
⚠ Skipped, system file		-	Backup Plus/Toolkit/Mirror/Icon

1. Open Toolkit.
2. On the Main Menu, click on the [Mirror](#) activity.
3. Click the More icon ( ) and select [Report](#).

## Toolkit Mirror FAQ

Click [Toolkit Mirror FAQ](#) for answers to common questions about creating and using mirror folders.

# Backup Activity (Windows Only)

The Backup activity lets you create a plan customised for the content, storage device and schedule of your choosing. Backup is available for the Windows version of Toolkit.

## File types and procedure

Toolkit backs up your data but excludes program files, application data, temporary files, and other types of system files and folders.



For more details, click on [File paths and extensions excluded in Toolkit backup](#).

Toolkit initially saves a full backup of the selected data to your storage device when a Backup plan is created. With successive backups, Seagate only saves the data that has changed since the preceding backup. This helps reduce the time and space required for each scheduled backup.

## Locating backed up files

When Toolkit backs up files to your external storage device, it creates the following folder hierarchy on the drive:

`X:\Toolkit\Backup\Name\c\`



X indicates the drive letter assigned to your external drive by your computer. Your drive letter may be different and may change depending on the number of drives connected to your computer. **Name** is the name of your computer.

Within the `\Toolkit\Backup\Name\c\` folder, your backed up files are typically in a copy of the source user folder, however, this may vary depending on the settings you chose for the Backup plan.

## Viewing archived files

When you update files on your computer, your Backup plan will copy the previous version to the following archive folder:



X indicates the drive letter assigned to your external drive by your computer. Your drive letter may be different and may change depending on the number of drives connected to your computer. **Name** is the name of your computer.

## Set up a quick backup

You can quickly back up personal files with just a few clicks. Your personal files include all non-system files on Windows.

1. Open Toolkit.
2. On the Main Menu, click [Backup](#).
3. Click [Back Up Now](#).



[Back Up Now](#) is not an available option if you've already created a Backup plan.

Toolkit backs up your personal files and creates a new backup plan. The plan is set to continuously back up personal files to the storage device whenever files are added to your computer or changed. You can change details of the auto-generated plan — see [Edit a backup plan](#).

## Create a custom backup plan

A custom Backup plan lets you choose the content, device, and schedule for your backups.

1. Open Toolkit.
2. On the Main Menu, click on the [Backup](#) activity.
3. Click [Custom](#).
4. Proceed through the steps in [Define your Backup plan](#).

## Edit a backup plan

You can change the content, destination, and schedule of your Backup plan.

1. Open Toolkit.
2. On the Main Menu, click on the [Backup](#) activity.
3. Click on the More icon ( [...](#) ) and select [Edit](#).
4. Proceed through the steps in [Define your Backup plan](#).

# Define your backup plan

Toolkit guides you through the steps needed to define your Backup plan.

## Step 1: Select content

There are two ways to select the content to include in your backups: Basic and Advanced.

### Basic

1. Click the checkboxes to include the following non-system content:

All files	Windows root drive
Personal files	User folder
Documents	Documents library
Music	Music library
Pictures	Pictures library
Videos	Videos library

2. When you're finished selecting content, click [Next](#).

### Advanced

1. To select content with greater control, click [Advanced](#).
2. Use the sidebar and the content window to manually select folders.

Selecting multiple items



You can select (highlight) multiple items using the **Shift** or **Ctrl** key on your keyboard.

To select a series of items in a list:

1. Click on the first folder.
2. Hold down the **Shift** key on your keyboard.
3. Click on the last folder.

To select multiple, non-consecutive items anywhere on the computer:

1. Click on a folder.
2. Hold down the **Ctrl** key on your keyboard.
3. Continue to click on folders.

When you're finished selecting content, click [Next](#).

## Step 2: Select the destination drive

1. Click the destination drive for your backup.
2. Once you've selected a device, click [Next](#).

## Step 3: Schedule backups

1. Click on a time period to select how often you want to back up your content.
2. Adjust settings for the selected time period, for example, selecting a specific hour or day.
3. Click [Start Backup](#).

Your changes are saved. Toolkit backs up selected folders at the scheduled time when:

- Your PC is on.
- Your storage device is connected to the PC.
- Toolkit is running.



A continuous backup plan saves a file whenever you add or remove content or update a file. While continuous backups provide greater flexibility to restore specific data, it uses more system resources.

## Pause/resume a backup plan

You can pause your scheduled backups.

1. Open Toolkit.

2. On the Main Menu, click on the [Backup](#) activity.
3. Click [Pause](#) on your drive.

To resume the backup plan, return to the Backup screen and click [Resume](#).

## Delete a backup plan

1. Open Toolkit.
2. On the Main Menu, click on the [Backup](#) activity.
3. Click the More icon ( [...](#) ) and select [Delete](#).
4. (optional) If you want to remove all files that have been backed up to the device, select the checkbox next to [Delete all files backed up to the device](#).
5. Click [Delete](#) to confirm.

## Restore files

1. Open Toolkit.
2. On the Main Menu, click on the [Backup](#) activity.
3. Click the More icon ( [...](#) ) select [Restore](#).
4. Proceed through the steps.

## View report

You can review a report of backup activity. The report lists files that were not backed up or only partially backed up, and includes details on the cause as well as file paths on the host computer and backup drive.

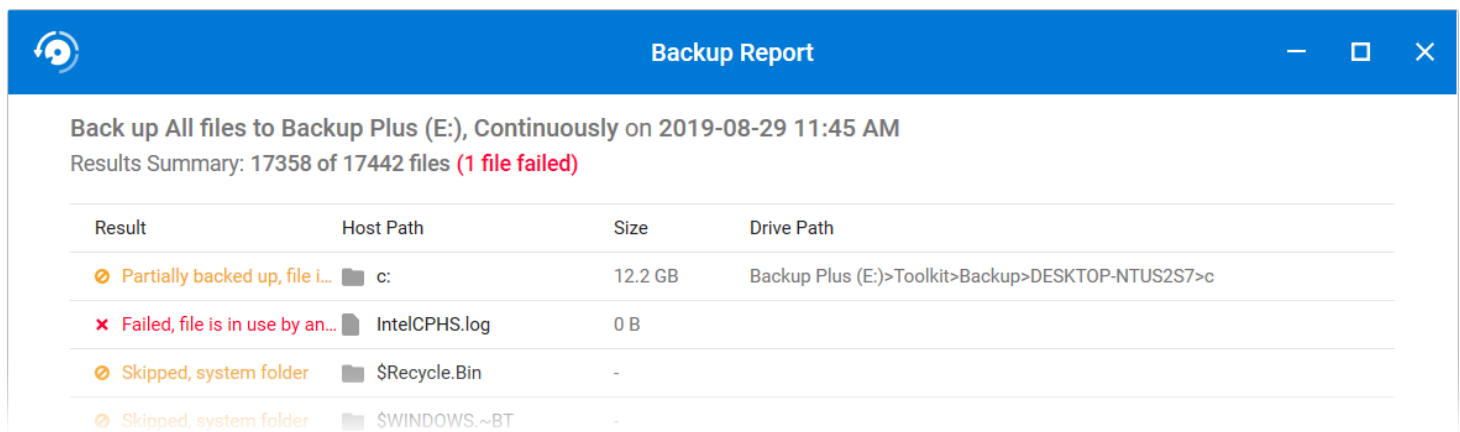

The screenshot shows a window titled "Backup Report" with a blue header. Below the header, the text reads: "Back up All files to Backup Plus (E:), Continuously on 2019-08-29 11:45 AM" and "Results Summary: 17358 of 17442 files (1 file failed)". Below this is a table with four columns: Result, Host Path, Size, and Drive Path. The table contains four rows of data.

Result	Host Path	Size	Drive Path
⚠ Partially backed up, file i...	c:	12.2 GB	Backup Plus (E:)>Toolkit>Backup>DESKTOP-NTUS2S7>c
✖ Failed, file is in use by an...	IntelCPHS.log	0 B	
⚠ Skipped, system folder	\$Recycle.Bin	-	
⚠ Skipped, system folder	SWINDOWS.~BT	-	

1. Open Toolkit.
2. On the Main Menu, click on the [Backup](#) activity.
3. Click the More icon ( [...](#) ) and select [Report](#).

# Toolkit Backup FAQ

Click [Toolkit Backup FAQ](#) for answers to common questions about creating and using Backup plans.

# Restore Activity (Windows Only)

You can retrieve files that you have backed up to your external drive through the Toolkit Backup plan.

1. Open Toolkit.
2. On the Main Menu, click [Restore](#).
3. Select the Backup plan you want to restore.
4. On the Restore screen, select the version you want to restore. Click [Next](#).
5. By default, Toolkit will restore files to their original locations. (If you want to restore files to a different location, use the sidebar and the content window to select a folder. You can always click [Restore to Original Location](#) to reset to the default location.)
6. Click [Restore](#).

Toolkit will restore the files from the version you selected. It will not restore files from other versions that may have been backed up to your external drive.



## Restoring files to other folders or computers

When restoring files to a different folder or computer, the file structure in the destination location may not match the file structure in the source location. Toolkit will recreate the source folder structure in the new location if file paths don't match. Depending on how your folders are organised, you may need to manually move restored files to their appropriate destinations.

# Sync Plus Activity



The Sync Plus activity provides a continual sync of data between your computer and your drive, ensuring your files are available in both places.

---

## Stay in sync

Sync folders on your PC or Mac with folders on your drive. Whenever you add, edit, or delete files on one device, Sync Plus automatically updates the files on the other.

---

## Archive deleted files

Automatically copy files you've deleted to the archive folder on your drive.



Toolkit will not sync some types of data. See [Files and folders excluded from syncing](#).

Sync Plus is available for the following premium products:

Supported devices	Product support page	User manual
Seagate One Touch SSD	<a href="#">Product</a>	<a href="#">Documentation</a>
LaCie Rugged SSD Pro	<a href="#">Product</a>	<a href="#">Documentation</a>

## Set up a quick sync

You can quickly create a plan to sync your PC or Mac's user folder. Toolkit performs the following actions in a quick sync:

- Creates a default plan syncing your PC or Mac's user folder with your drive.
- Files and folders you delete are automatically copied to the archive folder on the drive.

To create a quick sync:

1. Open Toolkit.
2. On the Main Menu, click on the [Sync Plus](#) activity.
3. Click [Sync](#).
4. Review settings and click [Got It](#).

## Create a custom Sync Plus plan

A custom Sync Plus plan lets you:

- Choose folders to sync with your drive.
- Customize your sync and archive settings.

To set up your custom Sync Plus plan:

1. Open Toolkit.
2. On the Main Menu, click on a drive.
3. Click [Create a new Sync Plus plan](#).
4. Click [Next](#).
5. Select the computer folders you want to sync. Click [Next](#).
6. Select the destination on your drive for the synced folder(s). Click [Next](#).
7. Click on the toggle switches to change the following settings:

Setting	On	Off
<b>2-way sync</b>	Changes made to files on your computer are synced with your drive, and vice versa.	<ul style="list-style-type: none"><li>• Your drive stays synced to changes made to files on your computer. However, changes made to files on your drive are not synced to your computer.</li><li>• Files deleted from your computer are not deleted from your drive.</li><li>• Turning off 2-way sync disables the <code>Archive deleted files</code> option.</li></ul>
<b>Archive deleted files</b>	Files and folders deleted from your computer or drive are saved to the archive folder. Turning off 2-way sync disables the <code>Archive deleted files</code> option.	Deleted files and folders are not saved. Turning off 2-way sync disables the <code>Archive deleted files</code> option.

8. Click [Create](#).

9. Review settings and click [Got It](#).

## Pause/resume a Sync Plus plan

To pause a Sync Plus plan:

1. Open Toolkit.
2. On the Main Menu, click on a drive.
3. On the Sync Plus plan, click [Pause](#).

To resume the Sync Plus plan, click [Resume](#).

## View synced folders and archive

To view synced folders and archives in your file manager:

1. Open Toolkit.
2. On the Main Menu, click on a drive.
3. On the Sync Plus plan, click [View](#).

## Edit a Sync Plus plan

To edit a Sync Plus plan:

1. Open Toolkit.
2. On the Main Menu, click on a drive.
3. On the Sync Plus Plan, click on the More icon ( [...](#) ) and select [Edit](#).
4. Select source and destination folders, and change sync and archive settings as needed.

## Delete a Sync Plus plan

To delete a Sync Plus plan:

1. Open Toolkit.
2. On the Main Menu, click on a drive.
3. On the Sync Plus Plan, click on the More icon ( [...](#) ) and select [Delete](#).
4. Click [OK](#) to confirm.

## Restore files

To restore files from the archive:

1. Open Toolkit

1. Open Toolkit.
2. On the Main Menu, click on a drive.
3. On the Sync Plus Plan, click on the More icon ( **...** ) and select [Restore](#).
4. Toolkit opens a file browsing window so you can copy data from the archive folder to another location.

## Files and folders excluded from syncing

Toolkit will not sync program files, application data, temporary files, and other types of system files and folders. A full listing of items excluded from syncing can be found in this [knowledge base article](#).



# Seagate Secure

The Seagate Secure activity lets you manage security for Seagate and LaCie self-encrypting drives. Use Toolkit to enable security, create a password, and rest easy knowing your data is protected with AES 256-bit encryption technology.



Supported devices	Product support page	User manual
LaCie Mobile SSD Secure	<a href="#">Product</a>	<a href="#">Documentation</a>
LaCie Rugged RAID Shuttle	<a href="#">Product</a>	<a href="#">Documentation</a>
LaCie Rugged Secure	<a href="#">Product</a>	<a href="#">Documentation</a>
LaCie Rugged SSD	<a href="#">Product</a>	<a href="#">Documentation</a>
Seagate Backup Plus Ultra Touch	<a href="#">Product</a>	<a href="#">Documentation</a>
Seagate One Touch with Hub	<a href="#">Product</a>	<a href="#">Documentation</a>
Seagate One Touch with Password	Not available in all countries.	Not available in all countries.

## Enable security with Toolkit

Toolkit is required to enable security for self-encrypting drives.

1. Connect the device to your computer.
2. Open Toolkit.
3. On the Main Menu, click on the Seagate Secure activity.
4. Click [Enable](#).

macOS 10.13 or later



A driver needs to be installed. At the prompt, use the Finder to eject the drive, and then disconnect the cable from the computer. Toolkit will prompt you to enable a system extension. Click [Next](#) to navigate to your Security & Privacy System Preferences and enable the system extension signed by “Seagate Technologies LLC”.

#### Apple Silicon Mac users

You must lower security before you can enable the system extension in Security & Privacy. For more details, see [How to change startup disk security settings on an Apple silicon Mac](#).

5. A notice appears informing you that you will create a password that you must remember or keep safe, as it can't be recovered. Click the checkbox to acknowledge the notification, and then click [Next](#).
6. Enter the 8-character secure code (SID) listed on the insert that was included in your device packaging. Note that the secure code is case-sensitive, meaning that it distinguishes between upper-case and lower-case letters. Click [Next](#).



If you no longer have the insert, you can find the secure code (SID) on a sticker on the drive enclosure. **Note for LaCie Rugged Secure and Rugged RAID Shuttle drives**—the sticker is located under the protective bumper.

7. Click [Next](#).



**Incorrect code** error? If you receive an **Incorrect code** error and can no longer enter the secure code (SID), safely eject the hard drive and then disconnect it from the computer. Locate the correct SID, reconnect the drive, and try again. This error could also occur if you enabled security for the device at some point in the past and the password you created is still active. Try entering the last password you created for the drive.

8. Create a password that you will use to unlock the drive on any computer. In the upper field, enter a password that's easy to remember but difficult to guess. Note that the password you create is case-sensitive, meaning that it distinguishes between upper-case and lower-case letters. Enter the same password in the lower field to confirm, and click [Next](#).



Keep your password in a safe place. Similar to mobile phones, your password cannot be recovered, not even by Seagate or LaCie.

9. (optional) Create a password hint. In the event you forget your password, you can view your hint to help you remember it. Enter your password hint and click [Next](#).



Because personal details can limit data security, use a hint that only you understand.

## Optional password reset key setup

You can set up a key that lets you reset your password if you forget your current password, while preserving the data on your drive.

At the prompt, enter your Seagate/LaCie account information and click [Sign In](#). If you don't have a Seagate/LaCie account, click [Create Account](#) to open a web page where you can create one. You'll need to validate and activate your new account.

After the password reset key has been created, make certain to note your Seagate/LaCie account information in case you need it to reset the password at a future date. See [Set up a password reset key](#) and [Use a password reset key](#) for more details.

10. Click [Done](#).

## Unlock the drive

To access data on the drive, you must enter the password you created with the Toolkit app. You can enter your password using Toolkit. If Toolkit is not installed on the computer, you can run the appropriate Unlock Drive app for your operating system located on the drive.

## Entering your password with Toolkit

Each time you connect your drive to a computer with Toolkit installed, you'll be prompted to enter your password.

1. At the prompt, enter the password you created when you enabled security.



Remember, the password you created is case-sensitive, meaning that it distinguishes between upper-case and lower-case letters.

2. Click [Continue](#).

If the prompt doesn't appear automatically when you connect the drive:

1. Open Toolkit.

2. On the Main Menu, click on the device.
3. Click [Unlock](#).
4. At the prompt, enter your password.
5. Click [Continue](#).

## Entering your password with the Unlock Drive app

If you connect the device to a computer that does not have Toolkit installed, you can enter your password using the Unlock Drive app located on the drive.

1. Using a file manager such as File Explorer or Finder, open the DriveLocked volume.
2. Click on [Unlock Drive for Windows](#) or [Unlock Drive for Mac](#).

### macOS 10.13 or later



A driver needs to be installed. At the prompt, use the Finder to eject the drive, and then disconnect the cable from the computer. Toolkit will prompt you to enable a system extension. Click [Next](#) to navigate to your Security & Privacy System Preferences and enable the system extension signed by “Seagate Technologies LLC”.

#### Apple Silicon Mac users

You must lower security before you can enable the system extension in Security & Privacy. For more details, see [How to change startup disk security settings on an Apple silicon Mac](#).

3. Enter the password you created for the drive.



Remember, the password you created is case-sensitive, meaning that it distinguishes between upper-case and lower-case letters.

4. Click [OK](#).



The Unlocker app is not available for high-capacity (12TB and higher) versions of Seagate One Touch with Hub. The Toolkit app must be used to unlock the drive.

## Exceeding the maximum number of failed password attempts

If you reach the maximum number of consecutive failed password attempts, your drive will be temporarily disabled. Disconnect and reconnect your drive, and then retry with the correct password.

# Lock the drive

The drive is locked automatically whenever it is ejected or disconnected from your computer. You must enter your password again when you reconnect the drive.

You can also manually lock the drive while it's connected to a computer.

1. Open Toolkit.
2. On the Main Menu, click on the device.
3. Click [Lock](#).
4. Enter your password and click [Continue](#).



Remember, the password you created is case-sensitive, meaning that it distinguishes between upper-case and lower-case letters.

# Change your password

Use Toolkit to change your password.

1. Open Toolkit.
2. On the Main Menu, click on the device.
3. Click on the More icon ( [•••](#) ) and select [Change Password](#).
4. A notice appears informing you that you will create a password that cannot be recovered. Click [Next](#).
5. In the upper field, enter your current password.
6. Enter your new password in the middle field, and then enter the same new password in the lower field to confirm.
7. (Optional) You can create a password hint, which you can view later in the event you've forgotten your password. Enter the password hint in the field.



Because personal details can limit data security, use a hint that only you understand.

8. Click [Next](#).
9. You've now secured the drive with a new password. Click [Done](#).

# Set up a password reset key

You can set up a key that lets you reset your password if you forget your current password, while preserving the data on your drive.

# Requirements

- Set up the password reset key before you forget your current password.
- A Seagate/LaCie account is required to set up a password reset key. [Create a new account](#), or [sign in with an existing account](#). An internet connection is required. New users will need to validate and activate their new account.
- Multi-user drives—Only an admin can set up and use a password reset key.
- The password key feature is available in Seagate Secure version 3.0 or higher. To view your Toolkit version:
  1. From the Home screen, click on the More menu and select [Settings](#).
  2. Click [About](#).



**Important note**—Like a good insurance policy, a password reset key is only useful if you set it up before you need it. If you forget your password but did not previously set up a password reset key, your only recourse is to [reset the drive to factory settings](#). A factory reset erases all data from the drive.

## Password reset key setup after security is enabled

You're prompted to set up a password reset key when [enabling security for your drive](#). However, if security has already been enabled, you can set up a password reset key using the Seagate Secure activity menu:

1. Open Toolkit.
2. On the Main Menu, click on the device.
3. Click on the More icon (  ) and select [Reset Key](#).
4. Click [Create](#).
5. Enter your current Seagate Secure admin password. Click [Continue](#).
6. You're prompted to enter your PSID. This is the 32-character reset code listed on the insert that was included in your device packaging. Enter the 32-character PSID. (Toolkit will automatically change lower-case letters to upper-case.)

### No longer have the insert with the PSID?

You can also find the PSID on a sticker on the hard drive. **Note for LaCie Rugged Secure and Rugged RAID Shuttle drives**—the sticker is located under the protective bumper.

7. At the prompt, enter your Seagate/LaCie account information and click [Sign In](#). An internet connection is required.



If you don't have a Seagate/LaCie account, click [Create Account](#) to open a web page where you can create an account. You'll need to validate and activate your new account.

After the password reset key has been created, make certain to note your Seagate/LaCie account information in case you need it to reset the password at a future date.

## Use a password reset key

If you previously set up a password key, you can use it to reset the drive's password.

1. At the password prompt, click [Forgot password?](#)
2. You're prompted to enter your PSID. This is the 32-character reset code listed on the insert that was included in your device packaging. Enter the 32-character PSID. (Toolkit will automatically change lower-case letters to upper-case.)

### No longer have the insert with the PSID?

You can also find the PSID on a sticker on the hard drive. **Note for LaCie Rugged Secure and Rugged RAID Shuttle drives**—the sticker is located under the protective bumper.

3. At the prompt, enter your Seagate/LaCie account information and click [Sign In](#). An internet connection is required.
4. On the Password Reset screen, enter your new password, and then enter the same new password in the field below it to confirm.
5. (optional) You can create a password hint, which you can view later in the event you forget your password again. Enter the password hint in the field.
6. (optional) Click the [Trusted computer](#) checkbox configure Toolkit to [automatically unlock a drive when it's connected to a trusted computer](#).
7. Click [Next](#).
8. Click [Done](#).

## Trusted computers

You can configure Toolkit to automatically unlock a drive when it's connected to a computer that you've designated as "trusted". Use this setting only on a computer that no one else uses. You'll still need a password to unlock the drive when connected to other computers.

1. Connect your drive to a computer installed with Toolkit.
2. At the prompt, enter the password you created when you enabled security.



Remember, the password you created is case-sensitive, meaning that it distinguishes between upper-case and lower-case letters.

3. Check the [Trust this computer](#) checkbox.
4. Click [Continue](#).

If the prompt doesn't appear automatically when you connect the drive:

1. Open Toolkit.
2. On the Main Menu, click on the device.
3. Click [Unlock](#).
4. At the prompt, enter your password.
5. Check the [Trust this computer](#) checkbox.
6. Click [Continue](#).

If your connected drive is already unlocked, do the following:

1. Open Toolkit.
2. On the Main Menu, click on the device.
3. Click on the More icon ( [...](#) ) and select [Trusted Computer](#).
4. Click the [Trust this computer](#) toggle to enable the setting.
5. At the prompt, enter your password and click [Continue](#).
6. Click [Done](#).

## Removing trusted computer status

To remove trusted computer status from a computer:

1. Connect your drive to the trusted computer.
2. Open Toolkit.
3. On the Main Menu, click on the device.
4. Click on the More icon ( [...](#) ) and select [Trusted Computer](#).
5. Click the [Trust this computer](#) toggle to disable the setting.
6. Click [Done](#).

## Disable security

You can disable security so that a password is no longer needed to unlock the device. It will function as an unsecured drive with no password protection. You can always re-enable security again at a later date using the password you created.

1. Open Toolkit.
2. On the Main Menu, click on the device.
3. Click on the More icon ( [...](#) ) and then click [Disable](#).
4. A notification appears informing you that you will disable security. Enter your password to confirm, and then click [Continue](#).

## Re-enable security

If you disabled security at some point, you can re-enable it using the password you created.



1. Open Toolkit.
2. On the Main Menu, click [Enable](#).
3. Enter the password you created when you first enabled security.



Remember, the password you created is case-sensitive, meaning that it distinguishes between upper-case and lower-case letters.

4. Click [Continue](#).

## Multi-user access

You can provide a second user with secure access to your storage device.



Multi-user is not available for high-capacity (12TB and higher) versions of Seagate One Touch with Hub.

Adding another user changes the unlock prompt when connecting the secure drive to a computer. When only a single user is enabled, the secure drive requires a single password for the owner or 'admin' of the drive:

Unlock Backup Plus Ultra Touch

..... 

Trust this computer

Cancel [Continue](#)

With multi-user enabled, the user unlocking the drive must enter both their username and password.

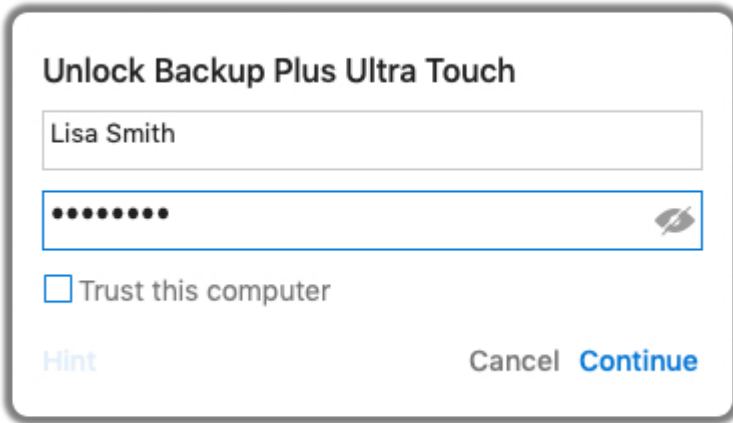

As the owner of the secure drive, your username is "Admin" and you continue to enter the same password. You'll provide the second user with a username and an initial password. The second user can access content on the drive but cannot perform all security actions:

Secure Actions	Admin	User
Change Password	✓	✓
Password Reset Key	✓	✗
Disable Security	✓	✗
Trusted Computer	✓	✓
Manage Multi-User	✓	✗
Crypto-Erase	✓	✗
Reset	Anyone with the PSID can reset the drive	

1. Open Toolkit.
2. On the Main Menu, click on the device.
3. Click on the More icon ( **...** ) and select [Manage Multi-User](#).
4. Click the [Multi-user](#) radio button, and then click [Next](#).
5. You're prompted to confirm your administrator password. Enter your password and click [Next](#).
6. Click [Add User](#). A dialog box appears.
7. Enter a username for the second user. This is the username the second user will enter when unlocking the drive.
8. Enter a password for the second user. This is the password the second user will enter when unlocking the drive. Choose a password that's easy to remember but difficult to guess. Note that the password you create is case-sensitive, meaning that it distinguishes between upper-case and lower-case letters.
9. Enter the same password in the lower field to confirm.
10. (optional) Create a password hint. You can create a hint to help you remember the password you created for the second user.



Because personal details can limit data security, use a hint that only you understand.

11. Click [Save](#).

## Editing the second user

The administrator can edit the second user's username and password.

1. Open Toolkit.
2. On the Main Menu, click on the device.
3. Click on the More icon ( [...](#) ) and select [Manage Multi-User](#).
4. At the prompt, enter your admin password and click [Continue](#).
5. In the user listing, click on the More icon ( [...](#) ) and select [Edit](#).
6. Edit the user's details and click [Save](#).
7. Click [Done](#).

## Disabling the second user

The administrator can disable the second user but maintain their details so they can be re-enabled later.

1. Open Toolkit.
2. On the Main Menu, click on the device.
3. Click on the More icon ( [...](#) ) and select [Manage Multi-User](#).
4. At the prompt, enter your admin password and click [Continue](#).
5. In the user listing, click on the More icon ( [...](#) ) and select [Disable](#).
6. At the prompt, click [Disable](#) to confirm.
7. Click [Done](#).

## Deleting the second user

The administrator can delete the second user.

1. Open Toolkit.
2. On the Main Menu, click on the device.
3. Click on the More icon ( [...](#) ) and select [Manage Multi-User](#).
4. In the user listing, click on the More icon ( [...](#) ) and select [Delete](#).
5. At the prompt, click [Delete](#) to confirm.
6. Click [Done](#).

## Crypto-erase the drive

A crypto-erase securely deletes all data on the drive—it can never be recovered—while keeping your

security settings in place. Your password remains the same.

1. Open Toolkit.
2. On the Main Menu, click on the device.
3. Click on the More icon ( **...** ) and then click [Crypto Erase](#).
4. A notification appears informing you that you will erase all the data on the drive but maintain your security settings. Click [Erase](#).
5. A dialog box appears. Enter your password to confirm, and then click [Continue](#).



If you are logged in to your computer as an admin user, confirm that you want to allow Toolkit to make this change. If you are logged in as a standard user, enter the system password for your computer to confirm the crypto-erase.



Mac®

Your system prompts you to allow Toolkit to make this change. Enter the system password for your computer to confirm the crypto-erase.

## Reset the drive to factory settings

A factory reset deletes all data on the drive and removes all security settings, including your password. The drive reverts to its original factory settings.

1. Open Toolkit.
2. On the Main Menu, click on the device.
3. Click on the More icon ( **...** ) and then click [Reset](#).
4. A notification appears informing you that you will erase all the data on the drive and remove your security settings. Click [Reset](#).
5. You're prompted to enter your PSID. This is the 32-character reset code listed on the insert that was included in your device packaging. Enter the 32-character PSID. (Toolkit will automatically change lower-case letters to upper-case.)

### No longer have the insert with the PSID?

You can also find the PSID on a sticker on the hard drive. **Note for LaCie Rugged Secure and Rugged RAID Shuttle drives**—the sticker is located under the protective bumper.

6. Click [Continue](#).



If you are logged in to your computer as an admin user, confirm that you want to allow Toolkit to make this change. If you are logged in as a standard user, enter the system password for your computer to confirm the factory reset.



Mac®

Your system prompts you to allow Toolkit to make this change. Enter the system password for your computer to confirm the factory reset.



# Import

Import lets you quickly import files from memory cards inserted into integrated card readers on compatible Seagate or LaCie devices. Insert a memory card, and Toolkit automatically copies your files to your device — no need to open folders and drag files.

Import also supports automated file copying from USB drives connected to hub ports on compatible Seagate and LaCie devices. Connect a USB flash drive or storage device to a hub port and let Toolkit back up files to your hub drive.

Unlike other features in Toolkit, Import is not available as an activity on the home screen. Instead, copying is automated or prompted when drives are detected.

Supported devices	Card Imports	USB Imports	Product support	User manual
LaCie 1big Dock	Yes	No	<a href="#">Product</a>	<a href="#">Documentation</a>
LaCie 1big Dock SSD Pro	Yes	No	<a href="#">Product</a>	<a href="#">Documentation</a>
LaCie Rugged RAID Pro	Yes	No	<a href="#">Product</a>	<a href="#">Documentation</a>
Seagate Backup Plus Hub	No	Yes	<a href="#">Product</a>	<a href="#">Documentation</a>
Seagate DJI Fly Drive	Yes	No	<a href="#">Product</a>	<a href="#">Documentation</a>
Seagate One Touch with Hub	No	Yes	<a href="#">Product</a>	<a href="#">Documentation</a>

## Install Import

Toolkit must already be installed on your computer. See [Getting Started with Toolkit](#).

1. Once Toolkit is installed, connect your supported Seagate or LaCie device to your computer.
2. Toolkit automatically detects the supported device and adds Import to Toolkit.

## Import from memory cards

1. Insert a memory card containing files into your Seagate or LaCie drive's integrated card reader. Toolkit asks you whether you want to automatically import the content of inserted cards to your storage drive.
2. Click [Import](#) to confirm that you want Toolkit to automatically copy files from memory cards. If you prefer

to activate Import at a later time, click [Skip](#).

When Import is activated, Toolkit will automatically copy files from memory cards inserted in an integrated card reader.

Toolkit may duplicate files in certain circumstances, for example, if you:

- Eject a memory card, remove the card from the drive, and then reinsert the card.
- Eject the drive and then reconnect the drive while the memory card is still inserted.
- Restart your computer while the device is connected and the memory card is inserted.
- Quit Toolkit and restart the app while the device is connected and the memory card is inserted.

## Activate/deactivate memory card imports

By default, Toolkit will import files from memory cards inserted in a Seagate or LaCie drive's integrated card reader. However, if needed you can deactivate memory card imports.

1. On the Toolkit home screen, click on the More icon and select [Settings](#).
2. Click on the toggle switch next to [Import content of inserted memory cards](#).

## Activate/deactivate incremental imports for memory cards

By default, Toolkit will copy all files from a memory card inserted in your Seagate or LaCie drive's integrated card reader. However, you can save storage space and time by activating **incremental imports**. An incremental import only copies new files and will ignore files that were previously imported from the same memory card.

1. On the Toolkit home screen, click on the More icon and select [Settings](#).
2. Click on the toggle switch next to [Incremental copy of inserted memory cards](#).

## Import from USB devices

1. Connect a USB flash drive or USB external storage device to a hub port on your hub drive. Toolkit asks you if you want to import the contents of the connected drive.
2. Click [Import](#) to confirm that you want Toolkit to copy files from the USB drive. If you don't want to import files from the connected drive, click [Skip](#).



Each time you connect the same USB device to the hub port, Toolkit will prompt you to import files from the drive. Note that subsequent imports from the same USB device are always **incremental**, that is, only new files are copied to the drive, while files that were previously imported from the same USB device are ignored.

# Activate/deactivate import prompts for USB devices

By default, Toolkit will prompt you to import the contents of devices connected to USB hub ports. You can deactivate import prompts for connected USB devices.

1. On the Toolkit home screen, click on the More icon and select [Settings](#).
2. Click on the toggle switch next to [Import contents of drives connected to hub ports](#).

## Location of imported files

Toolkit creates the following folders for all of your imports: **DriveName** > Toolkit > Imported Files.



**DriveName** is the name of your Seagate storage device.

## Folder naming convention

During an import, Toolkit adds a uniquely named folder containing the imported files. The following naming convention is used:

YYYY-MM-DD\_HH.MM.SS\_

YYYY	Year
MM	Month
DD	Day
HH	Hour (24-hour clock)
MM	Minutes
SS	Seconds

The name of your memory card

## Toolkit Import FAQ

**Q: Does Import delete the content on my memory card after it has finished importing content to my drive?**

A: No. Files are not removed from the memory card while importing.



## Q: Can I use Import with an external card reader?

A: No. Import is designed for use with select Seagate and LaCie devices featuring integrated card readers. See [Supported devices](#) above.

# RAID Setup



Toolkit helps you easily configure the initial RAID level and formatting for compatible drives.

Supported devices	Product support page	User manual
LaCie 2big RAID	<a href="#">Product</a>	<a href="#">Documentation</a>
LaCie Rugged RAID Pro	<a href="#">Product</a>	<a href="#">Documentation</a>
LaCie Rugged RAID Shuttle	<a href="#">Product</a>	<a href="#">Documentation</a>

## Additional resources from LaCie RAID Manager

Toolkit is designed for quick configuration of your initial RAID level. Toolkit will not launch the RAID Setup wizard once the RAID level or drive format was changed from its factory setting.

Use LaCie RAID Manager if you need to make further changes to your RAID or drive format. LaCie RAID Manager helps you configure and manage arrays, set up important email alerts, measure the health of hard drives, and more.

### Learn more about LaCie RAID Manager

[LaCie RAID Manager for 2-Bay Devices](#)

[Download LaCie RAID Manager](#)

[Supported operating systems](#)

## RAID explained

RAID stands for **redundant array of independent disks**. RAID contains the word **array**, and the two terms are often used interchangeably. An array is a combination of two or more physical disks that are presented to the operating system as a single volume.

Disks are combined into different RAID configurations known as **RAID levels**. The RAID level you choose depends on which storage attributes are most important to you:

Capacity	The total amount of data you can store
Performance	The speed at which data is copied
Protection	The number of disks that can fail before data is lost

Toolkit RAID helps you initially configure select LaCie and Seagate RAID storage devices with two drives. Available levels are RAID 0 and RAID 1:

**RAID 0**—Data is not duplicated on both drives. This results in faster transfers and more storage, since the full capacity of both drives can be used to store unique data. However, RAID 0 lacks data protection. If a single drive fails, all data in the array is lost.

**RAID 1**—Data is duplicated on each disk in the array. If a drive fails, the data remains available on the other drive. However, this comes at a cost—since the same data is written to each drive, copying data takes longer and overall storage capacity is reduced by 50%. RAID 1 is a good choice when protecting your data is more important than performance or overall storage space.

To summarize, each RAID level has its own advantages:

RAID level	Capacity	Performance	Protection	Factory default
RAID 0	100%	Excellent	None	Yes
RAID 1	50%	Good	Excellent	No

## RAID and data security

While RAID 1 can protect data in case of a single drive failure, it cannot guarantee complete data protection for all cases of hardware failure or data corruption. To help prevent data loss due to any extreme event, it's recommended that you maintain copies of your files on more than one device—for example, keep one copy on your 2-bay device and another copy on one of the following:

- Another direct-attached storage (DAS) device
- A network attached storage (NAS) device
- Some form of removable or archival storage

Any loss, corruption or destruction of data while using a Seagate or LaCie hard drive or hard drive system is the sole responsibility of the user. Under no circumstances will Seagate or LaCie be held liable for the recovery or restoration of data.

## Setting RAID level and formatting with Toolkit

1. Follow the instructions in your product user manual for setting up your device and installing Toolkit.
2. Toolkit will prompt you to set the RAID level for the newly detected RAID device. (If you don't see the prompt—or you rejected it in the past—click on the RAID device on the Toolkit Main Menu.)

---

### Full Capacity and Better Transfers (RAID 0)

Configures the device as RAID 0. Full storage capacity is available for your files and your data transfers are faster. However, RAID 0 lacks an important feature: data protection. If a hard drive fails, all data in the array is lost.

---

### File Protection (RAID 1)

Configures the device as RAID 1. Each file is stored on both drives in the array, which means your data is still available if a single drive fails. However, storage space is cut by 50% and data transfers are not as fast as RAID 0.

3. Follow any additional onscreen instructions to complete the setup.



Toolkit will not launch the RAID Setup wizard if the RAID level or drive format was previously changed from its factory setting. See [Additional resources from LaCie RAID Manager](#).

# RGB and Status LED Management

Toolkit has options for managing the RGB and Status LED illumination on applicable storage devices.

<b>Pattern RGB</b>	Choose from preset patterns or create custom patterns of your own. Select colours that complement your work or play environment.
<b>Status LED</b>	Enable/disable status LED.

Storage device RGB and LED options:

Supported devices	Status LED	Single Colour RGB	Rainbow RGB	Product support	User manual
LaCie 1big Dock	Yes	No	No	<a href="#">Product</a>	<a href="#">Documentation</a>
LaCie 1big Dock SSD Pro	Yes	No	No	<a href="#">Product</a>	<a href="#">Documentation</a>
LaCie 2big RAID	Yes	No	No	<a href="#">Product</a>	<a href="#">Documentation</a>
Seagate FireCuda Gaming Dock	Yes	Yes	No	<a href="#">Product</a>	<a href="#">Documentation</a>
Seagate FireCuda Gaming Hard Drive	Yes	Yes	Yes	<a href="#">Product</a>	<a href="#">Documentation</a>
Seagate FireCuda Gaming Hub	Yes	Yes	Yes	<a href="#">Product</a>	<a href="#">Documentation</a>
Seagate FireCuda Gaming SSD	Yes	Yes	No	<a href="#">Product</a>	<a href="#">Documentation</a>

**i** **Game Drive for Xbox** – Toolkit RGB control can be used to set colour patterns and animations for select products. See the [Game Drive for Xbox Special Edition user manual](#) for instructions specific to your product.

## Disable/enable the status LED

The status LED is enabled by default. To disable or enable the status LED for your storage device:

1. Connect your storage device to your computer.

1. Connect your storage device to your computer.
2. Open Toolkit.
3. On the Home page, click on your storage device.
4. Click the **Status LED** switch to disable/enable the status LED.

## Edit RGB illumination patterns

The Toolkit RGB activity supports the following RGB pattern controls:

- Razer Chroma
- FireCuda RGB (default)

A single device can use only one colour management option.

## Access RGB activity

To access the RGB activity:

1. Connect your compatible storage device to your computer.
2. Open Toolkit.
3. On the Home page, click on the RGB Activity. The RGB Activity screen appears.

## RGB illumination settings

The following settings at the top of the RGB activity screen apply to all RGB pattern controls

- **Intensity** – Move the slider to the right to add more brightness to the RGB and to the left to decrease brightness.
- **On** – Click the switch to turn the RGB off/on.
- **Sync Seagate compatible devices** – This option is only available for Seagate FireCuda Gaming Dock and Seagate FireCuda Gaming SSD. If you have two or more compatible devices connected to your PC, you can click the switch to sync the RGB patterns for all devices. Once enabled on any of the connected RGB storage devices, all RGBs act in unison with changes to the patterns. (There is no primary or secondary device. The most recently edited setting defines the pattern for all of the synced devices.) Disabling this option reverts all devices to their default colour.

## Razer Chroma via Razer Synapse 3 app (Windows only)

Razer Chroma is a popular RGB video game software management protocol with a rich set of pattern and in-game options. All management is performed in the Razer Synapse application. You can use Razer Synapse for preconfigured RGB patterns or create new ones. Razer Synapse also supports a growing number of video games for RGB illumination that activates with colours matching in-game play. For further information about supported patterns and games as well as how to download the Razer Synapse application, go to the [Razer Synapse website](#).

## Requirements for Razer Chroma

- The latest version of Toolkit.
- Razer Synapse 3 software must be installed and running.
- Chroma Connect must be enabled in Razer Synapse 3.



**Important** — Toolkit RGB control is compatible with Razer Synapse 3 or higher. Razer Synapse 2 cannot control Seagate RGB storage device LEDs.

## Use Razer Chroma

To use Razer Chroma as the RGB controller, click **Enable** on the Razer Chroma activity card.

## FireCuda RGB app

FireCuda RGB is the native Toolkit RGB management protocol. It is enabled by default.

## Edit LED settings

The LED settings let you:

- Choose between single colour and rainbow patterns.
- Select preset and custom animations.
- Change colour and animation settings.
- Change global settings.

To edit LED settings, click on the Edit icon () on the FireCuda RGB activity. The LED Settings screen appears:

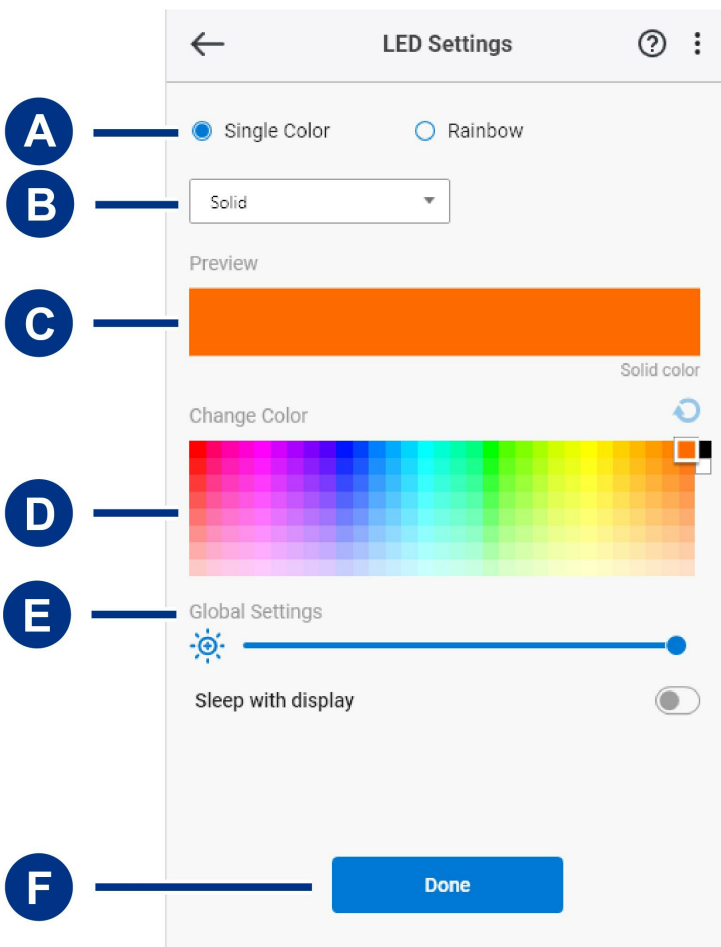

- A. **Select Pattern** – Choose whether to create a single colour or rainbow pattern. Single colour uses the entirety of the LEDs to display one colour at a time as the pattern animates. Rainbow includes up to six colours on the LEDs at a time as the pattern animates. Rainbow is not available for all drives (see the [product listing](#) above).
- B. **Select Animation** – Choose animation types for the selected pattern.
- C. **Preview** – Preview the current pattern/animation. Specify animation times.
- D. **Change Colour** – Add/remove colours for applicable animation.
- E. **Global Settings** – Change global settings.
- F. **Done** – Confirm changes to pattern/animation settings.

## Select a pattern

Choose a single colour or rainbow pattern. See the table below for the colour and timing controls available for each animation.

## Select an animation

Select from the following animation types:

Pattern	Animation	Description	Total animation time	User selections
---------	-----------	-------------	----------------------	-----------------



Single Colour	Solid	Displays a single colour continuously.	<ul style="list-style-type: none"> <li>• 100% colour hold</li> </ul>	<ul style="list-style-type: none"> <li>• Single colour</li> </ul>
Single Colour	Blink	Turns a single colour of your choosing on/off.	<ul style="list-style-type: none"> <li>• 6s <ul style="list-style-type: none"> <li>◦ 50% colour hold</li> <li>◦ 50% off</li> </ul> </li> </ul>	<ul style="list-style-type: none"> <li>• Single colour</li> </ul>
Single Colour	Breathe	Fades a single colour of your choosing on/off.	<ul style="list-style-type: none"> <li>• User selected (default=6s) <ul style="list-style-type: none"> <li>◦ 25% colour hold</li> <li>◦ 25% fade off</li> <li>◦ 25% off</li> <li>◦ 25% fade on</li> </ul> </li> </ul>	<ul style="list-style-type: none"> <li>• Single colour</li> <li>• Total animation time</li> </ul>
Single Single	Spectrum	Transitions between six colours: red, orange, yellow, green, blue and violet.	<ul style="list-style-type: none"> <li>• User selected (default=18s) <ul style="list-style-type: none"> <li>◦ 50% colour holds (8.33% per colour)</li> <li>◦ 50% colour transitions (8.33% per transition)</li> </ul> </li> </ul>	<ul style="list-style-type: none"> <li>• Total animation time</li> </ul>
Single Colour	Custom 1	Displays a custom animation you've created.	<ul style="list-style-type: none"> <li>• User selected (default=6s)</li> </ul>	<ul style="list-style-type: none"> <li>• Multiple colours</li> <li>• Colour hold time</li> <li>• Colour transition time</li> </ul>
Single Colour	Custom 2	Displays a custom animation you've created.	<ul style="list-style-type: none"> <li>• User selected (default=21s)</li> </ul>	<ul style="list-style-type: none"> <li>• Multiple colours</li> <li>• Colour hold time</li> <li>• Colour transition time</li> </ul>
Single Colour	Custom 3	Displays a custom animation you've created.	<ul style="list-style-type: none"> <li>• User selected (default=2s)</li> </ul>	<ul style="list-style-type: none"> <li>• Multiple colours</li> <li>• Colour hold time</li> <li>• Colour transition time</li> </ul>
Rainbow	Static	Displays a rainbow pattern continuously.	<ul style="list-style-type: none"> <li>• 100% colour hold</li> </ul>	<ul style="list-style-type: none"> <li>• N/A</li> </ul>
Rainbow	Breathe	Fades a rainbow pattern on/off.	<ul style="list-style-type: none"> <li>• 6s <ul style="list-style-type: none"> <li>◦ 50% colour hold</li> </ul> </li> </ul>	<ul style="list-style-type: none"> <li>• N/A</li> </ul>

Rainbow	Blink	Turns a rainbow pattern on/off.	<ul style="list-style-type: none"> <li>• 6s <ul style="list-style-type: none"> <li>◦ 25% colour hold</li> <li>◦ 25% fade off</li> <li>◦ 25% off</li> <li>◦ 25% fade on</li> </ul> </li> </ul>	<ul style="list-style-type: none"> <li>• N/A</li> </ul>
Rainbow	Slide	A rainbow pattern slides from right to left.	<ul style="list-style-type: none"> <li>• 1.8s</li> </ul>	<ul style="list-style-type: none"> <li>• N/A</li> </ul>
Rainbow	Custom 1	Displays a custom rainbow pattern continuously (static).	<ul style="list-style-type: none"> <li>• 100% colour hold</li> </ul>	<ul style="list-style-type: none"> <li>• Multiple colours</li> </ul>
Rainbow	Custom 2	Fades a custom rainbow pattern on/off (breathe).	<ul style="list-style-type: none"> <li>• User selected (default = 6s)</li> </ul>	<ul style="list-style-type: none"> <li>• Multiple colours</li> <li>• Colour hold time</li> <li>• Colour transition time</li> </ul>
Rainbow	Custom 3	Turns a custom rainbow pattern on/off (blink).	<ul style="list-style-type: none"> <li>• User selected (default = 3s)</li> </ul>	<ul style="list-style-type: none"> <li>• Multiple colours</li> <li>• Colour hold time</li> </ul>

## Preview selected pattern/animation

The Preview window lets you view the colours, transitions, and timing of the selected pattern/animation.

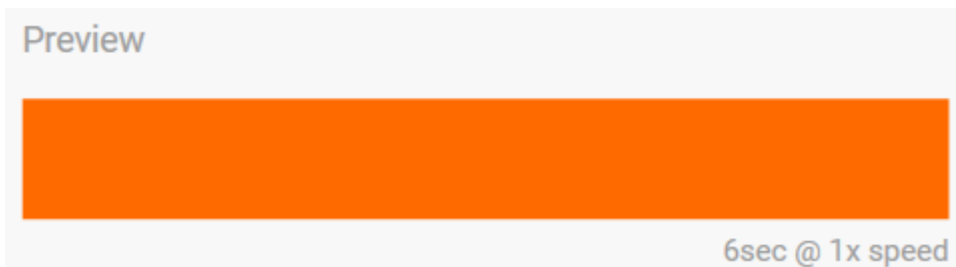

The device LEDs mimic the preview while you're editing.

The total animation time (the time it takes for one cycle of the pattern to be completed) appears below the Preview window:

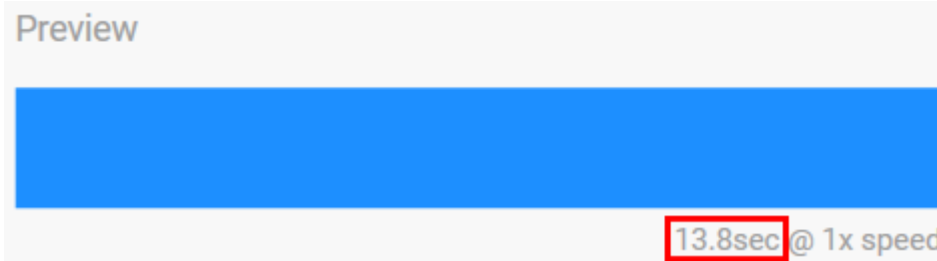

For longer total animation times (starting at 15 seconds), the Preview window will automatically speed up the playback animation so that you can see your changes faster. The current playback speed is displayed next to the total animation time.



## Timing controls

Some patterns/animations allow you to control the total time over which an animation is played. Use the slider to set the total animation time:



The total animation time is broken down evenly between colour holds and transitions.

Certain custom pattern/animations provide control over colour hold and/or transition settings:

- A. **Colour hold setting** – Represents the total time spent holding on colours. The total time is divided by the number of colours in the animation.
- B. **Colour transition setting** – Represents the total time spent transitioning from one colour to the next colour. The total time is divided by the number of transitions in the animation.

Use the sliders to control colour hold and transition times:



Note that the colour hold setting and colour transition setting together determine the total animation time.

## Change colours

### Single colour preset animations

Solid, Blink, and Breathe animations allow you to specify only one colour:

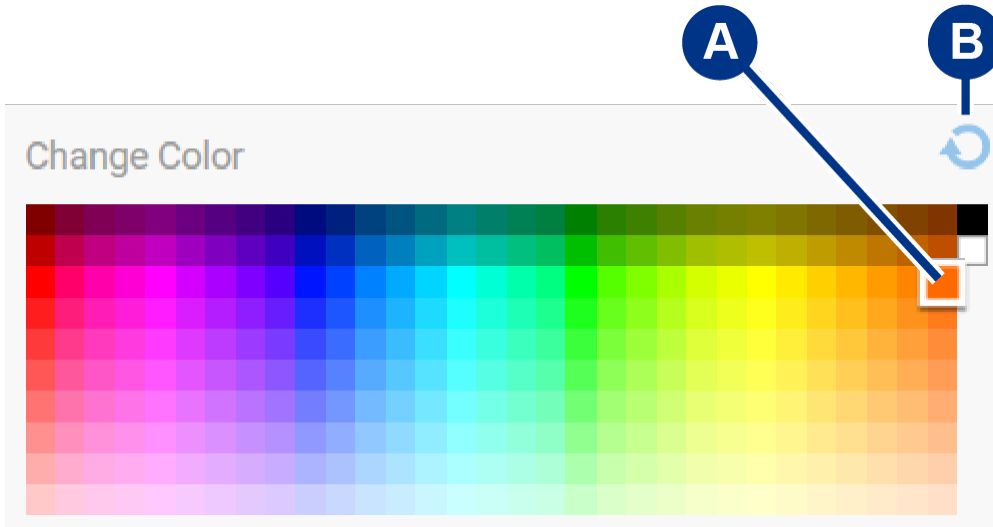

- A. Click on a colour to select it.
- B. Click on the Reset icon to select the default orange colour.

### Single colour and rainbow custom animations

Both single colour and rainbow custom animations allow you to specify multiple colours:

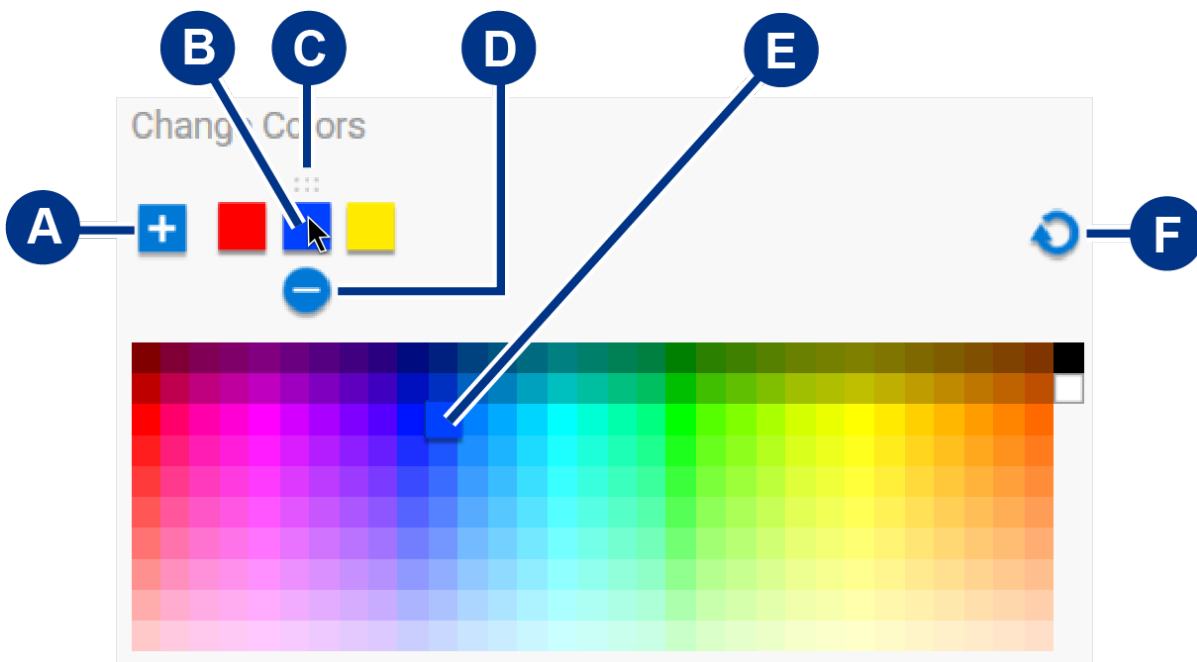

- A. Click on the Add icon to add a colour to the sequence. You can add up to six colours. (Only available for single colour custom animations. Rainbow custom animations always require six colours.)

- B. Click to select a colour in the sequence.
- C. Click on the Grid icon to drag the selected colour to a different position in the sequence.
- D. Click on the Remove icon to remove the selected colour from the sequence. (Only available for single colour custom animations. Rainbow custom animations always require six colours.)
- E. Click to change the selected colour.
- F. Click on the Reset icon to select the default colours and settings for the custom animation.

## Change global settings

Use the following settings to control your storage device's pattern LED:

Setting	Description
<b>Brightness</b>	Move the slider to control pattern LED brightness. The default setting is 100%.
<b>Always on</b>	When enabled, the pattern LED is illuminated whenever the storage device is powered on. Enabling <b>Always on</b> disables <b>Sleep with display</b> .
<b>Sleep with display</b>	When enabled, the pattern LED is not illuminated when the host computer is asleep or powered off. Enabling <b>Sleep with display</b> disables <b>Always on</b> .

# Settings

To view app settings as well as support, documentation, and software information, click the More icon ( **...** ) on the Main Menu and select [Settings](#).

## Toolkit app settings

### Start Toolkit automatically at startup

When enabled, Toolkit opens automatically when the computer is started. Note that Toolkit must be open in order to run scheduled backups.

### Enable Detailed Logs

When enabled, Toolkit records detailed logs that can be used to troubleshoot issues. Only enable if instructed by a Seagate or LaCie support representative.

## Import settings

Import settings are only available for compatible Seagate and LaCie drives with integrated card readers or hub ports. Click on the link for a [list of supported devices](#).

### Import content of inserted memory cards

When enabled, Toolkit automatically copies files from memory cards inserted in your Seagate or LaCie drive's integrated card reader.

When disabled, Toolkit will not read memory cards inserted in a card slot.

### Incremental copy of inserted memory cards

When enabled, copies from memory cards are **incremental**, that is, Toolkit will only copy new files and will ignore files that were previously imported from the same memory card.

When disabled, Toolkit will copy all files from the memory card each time it is inserted in a card slot, regardless of whether files have been previously copied.

## Import contents of drives connected to hub ports

When enabled, Toolkit will prompt you to copy files from USB storage devices connected to a hub port on the external drive.

When disabled, Toolkit will not prompt you to copy files from USB storage devices.

# Toolkit updates

Toolkit checks for updates provided the app is open and the computer is connected to the internet. Toolkit will automatically check for updates in the following events:

- The computer restarts and Toolkit is relaunched.
- You quit Toolkit and relaunch Toolkit.
- 24-hours have elapsed since the last check.

# About

Click [About](#) to view the following:

- **Toolkit app and activity versions.** When troubleshooting issues, a customer support representative may ask you for version numbers related to the Toolkit app and features.
- **Seagate and LaCie page links.**
  - Terms and Conditions
  - Privacy Statement
  - Software Legal Notices
  - End User Licence Agreement